

Service  
Service  
**Service**



# Service Manual



**TABLE OF CONTENTS**

Handling Chip Components and Safety .....1 - 1

Technical Specification & Service tools .....2 - 1

Service Measurement.....2 - 2

Connections and controls .....3 - 1

Instructions for use .....3 - 2 to 3 - 8

Disassembly Diagram.....4 - 1

Block Diagram .....5 - 1

Wiring Diagram.....5 - 2

**Front Board**

    Circuit diagram .....6 - 1

    layout diagram.....6 - 2

**Tuner Board**

    circuit diagram .....7 - 1

    layout diagram.....7 - 2

**Recorder Board**

    circuit diagram .....8 - 1

    layout diagram.....8 - 2

**Combi Board**

    circuit diagram .....9 - 1 to 9 - 6

    layout diagram.....9 - 7 to 9 - 8

Exploded view .....10 - 1

Mechanical partslist .....10 - 2

Electrical partslist.....10 - 2

© Copyright 2004 Philips Consumer Electronics B.V. Eindhoven, The Netherlands  
 All rights reserved. No part of this publication may be reproduced, stored in a retrieval  
 system or transmitted, in any form or by any means, electronic, mechanical, photocopying,  
 or otherwise without the prior permission of Philips.



Published by LX 0432 Service Audio Printed in The Netherlands Subject to modification

GB 3140 785 32800

**version 1. 0**



**PHILIPS**

# HANDLING CHIP COMPONENTS

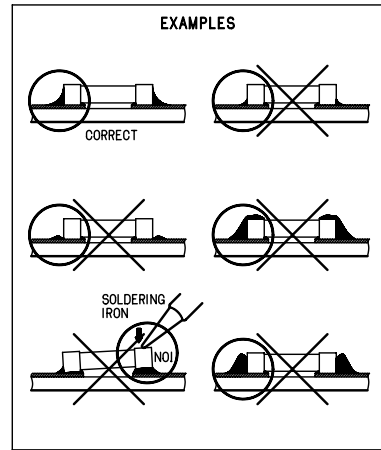
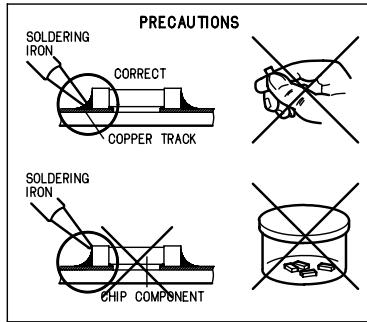
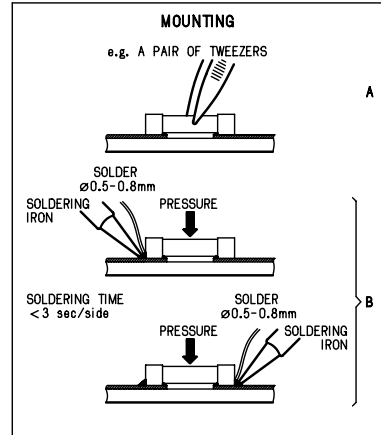
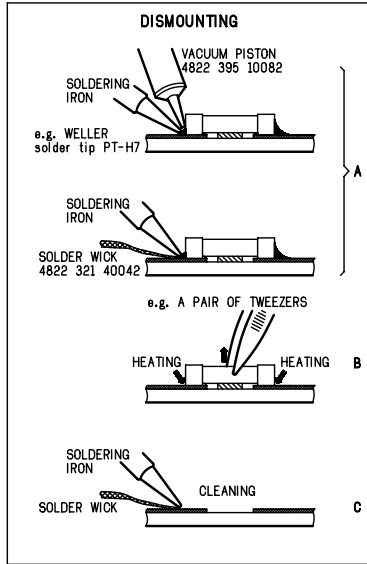
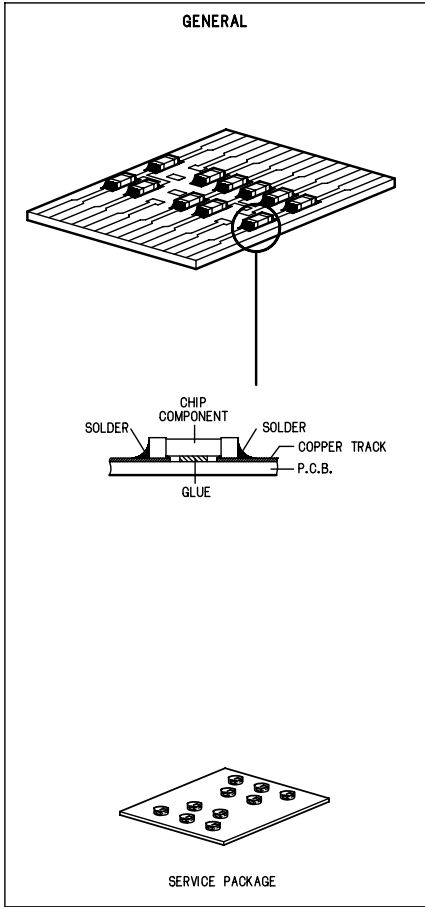

**(GB) WARNING**  
 All ICs and many other semiconductors are susceptible to electrostatic discharges (ESD). Careless handling during repair can reduce life drastically. When repairing, make sure that you are connected with the same potential as the mass of the set via a wristband with resistance. Keep components and tools at this potential.



**(NL) WAARSCHUWING**  
 Alle IC's en vele andere halfgeleiders zijn gevoelig voor electrostatische ontladingen (ESD). Onzorgvuldig behandelen tijdens reparatie kan de levensduur drastisch doen verminderen. Zorg ervoor dat u tijdens reparatie via een polsband met weerstand verbonden bent met hetzelfde potentiaal als de massa van het apparaat. Houd componenten en hulpmiddelen ook op ditzelfde potentiaal.

**(F) ATTENTION**  
 Tous les IC et beaucoup d'autres semi-conducteurs sont sensibles aux décharges statiques (ESD). Leur longévité pourrait être considérablement écourtée par le fait qu'aucune précaution n'est prise à leur manipulation. Lors de réparations, s'assurer de bien être relié au même potentiel que la masse de l'appareil et enfilez le braceleterti d'une résistance de sécurité. Veiller à ce que les composants ainsi que les outils que l'on utilise soient également à ce potentiel.

**(D) WARNUNG**  
 Alle ICs und viele andere Halbleiter sind empfindlich gegenüber elektrostatischen Entladungen (ESD). Unvorsichtige Behandlung im Reparaturfall kann die Lebensdauer drastisch reduzieren. Sorgen Sie dafür, daß Sie im Reparaturfall über ein Pulsarmband mit Widerstand mit dem Massepotential des Gerätes verbunden sind. Halten Sie Bauteile und Hilfsmittel ebenfalls auf diesem Potential.

**(I) AVVERTIMENTO**  
 Tutti IC e parecchi semi-conduttori sono sensibili alle scariche statiche (ESD). La loro longevità potrebbe essere fortemente ridatta in caso di non osservazione della più grande cauzione alla loro manipolazione. Durante le riparazioni occorre quindi essere collegato allo stesso potenziale che quello della massa dell'apparecchio tramite un braccialetto a resistenza. Assicurarsi che i componenti e anche gli utensili con i quali si lavora siano anche a questo potenziale.

**(GB)**  
 Safety regulations require that the set be restored to its original condition and that parts which are identical with those specified be used. Safety components are marked by the symbol ▲

**(F)**  
 Les normes de sécurité exigent que l'appareil soit remis à l'état d'origine et que soient utilisées les pièces de rechange identiques à celles spécifiées. Les composants de sécurité sont marqués ▲

## SAFETY



**(D)**  
 Bei jeder Reparatur sind die geltenden Sicherheitsvorschriften zu beachten. Der Originalzustand des Gerätes darf nicht verändert werden. Für Reparaturen sind Originalersatzteile zu verwenden. Sicherheitsbauteile sind durch das Symbol ▲ markiert.

**(NL)**  
 Veiligheidsbepalingen vereisen, dat het apparaat in zijn oorspronkelijke toestand wordt teruggebracht en dat onderdelen, identiek aan de gespecificeerde, worden toegepast. De Veiligheidsonderdelen zijn aangeduid met het symbool ▲

**(I)**  
 Le norme di sicurezza estigono che l'apparecchio venga rimesso nelle condizioni originali e che siano utilizzati i pezzi di ricambio identici a quelli specificati. Componenti di sicurezza sono marcati con ▲

**(GB) DANGER:** Invisible laser radiation when open. AVOID DIRECT EXPOSURE TO BEAM.

**(S) Varning!**  
 Osynlig laserstrålning när apparaten är öppnad och spårren är urkopplad. Betrakta ej strålning.

**(DK) Advarsel!**  
 Usynlig laserstrålning ved åbning når sikkerhedsafbrydere er ude af funktion. Undgå udsættelse for strålning.



**(FIN) Varoitus!**  
 Avatussa laitteessa ja suojalukituksen ohitettaessa olet alttiina näkymättömälle laserisäteilylle. Älä katso säteeseen!

**(GB)**  
 After servicing and before returning the set to customer perform a leakage current measurement test from all exposed metal parts to earth ground, to assure no shock hazard exists. The leakage current must not exceed 0.5mA.

**(F)**  
 Pour votre sécurité, ces documents doivent être utilisés par des spécialistes agréés, seuls habilités à réparer votre appareil en panne.

## TECHNICAL SPECIFICATIONS

### GENERAL

Mains voltage	-/01 : 120 / 230 V
Mains frequency -	-/01 : 50 / 60 Hz
Battery	: 9 V (R14 x 6)
Power consumption	: <35 W
Dimension (W x H x D)	: 400 x 235 x 173mm
Weight	: 3 Kg

### AMPLIFIER

Output power	mains : 2 x 1 W
	battery : 2 x 1 W
Speaker impedance	: 2 x 8 ohm
Frequency response	: 60 Hz - 20 kHz ( $\pm 3$ dB)

### TUNER - FM SECTION

Tuning range	: 87.35 - 108.25 MHz
IF frequency	: 10.7 MHz $\pm$ 0.2 MHz
Sensitivity	: <22 dB at 26dB S/N
Selectivity	: >20 dB at 300kHz
IF rejection	: >50 dB
Image rejection	: >20 dB

### TUNER - AM SECTION

Tuning range	: 512 - 1635 kHz
IF frequency	: 468 kHz $\pm$ 3 kHz
Sensitivity(nom.)	: 1500 $\mu$ V/m at 26dB S/N
Selectivity(nom.)	: 20 dB
IF rejection(nom.)	: 70 dB
Image rejection(nom.)	: 32 dB

### CASSETTE RECORDER

Number of tracks	: stereo
Tape speed	: 4.76 cm/sec
Wow & flutter	: < 0.35% JIS WTD
Fast wind/rewind C60	: <130 sec.
Frequency response	P/B : 125 - 8000 Hz
S/N ratio	: 36 dB

### COMPACT DISC

S/N ratio	: 60 dB typ.
Channel difference	1 kHz : 2 dB lim.
Channel crosstalk	1 kHz : 45 dB typ.
THD	1 kHz : <1.5 %

## SERVICE TOOLS

<b>Audio signal disc</b> SBC 429.....	4822 397 30184
<b>PI ayabil ity test disc</b> SBC 444.....	4822 397 30245
<b>Test disc 5</b> (disc without errors) +	
<b>Test disc 5A</b> (disc with dropout errors, black spots and fingerprints)	
SBC 426/426A.....	4822 397 30096
<b>Burn in test disc</b> (65 min. 1kHz signal at -30 dB level without "pause").....	4822 397 30155

## AVAILABLE ESD PROTECTION EQUIPMENT

<b>anti-static table mat</b> large 1200x650x1.25mm	4822 466 10953
small 600x650x1.25mm	4822 466 10958
<b>anti-static wristband</b>	4822 395 10223
<b>connection box</b> (3 press stud connections, 1M $\Omega$ )	4822 320 11307
<b>extendible cable</b> (3m, 2M $\Omega$ , to connect wristband to connection box)	4822 320 11305
<b>connecting cable</b> (3m, 2M $\Omega$ , to connect table mat to connection box)	4822 320 11306
<b>earth cable</b> (1M $\Omega$ , to connect any product to mat or to connection box)	4822 320 11308
<b>KIT ESD3</b> (combining all 6 prior products - small table mat)	4822 310 10671
<b>wristband tester</b>	4822 344 13999

## SERVICE MEASUREMENT

### Tuner SW

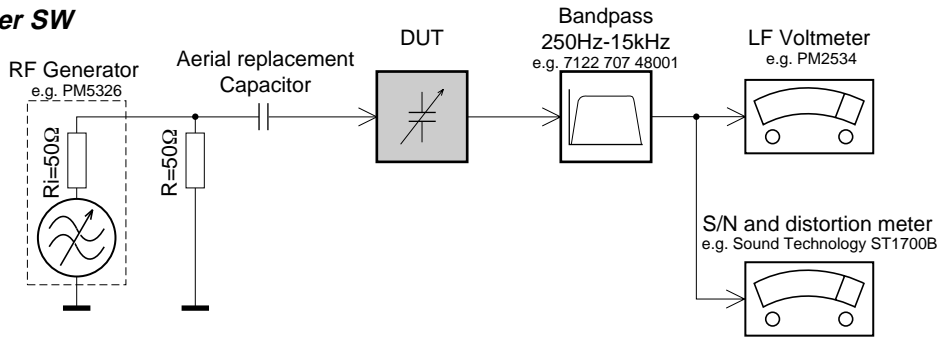

To avoid atmospheric interference all AM-measurements have to be carried out in a Faraday«s cage. Use a bandpass filter (or at least a high pass filter with 250Hz) to eliminate hum (50Hz, 100Hz).

### Tuner AM (MW, LW)

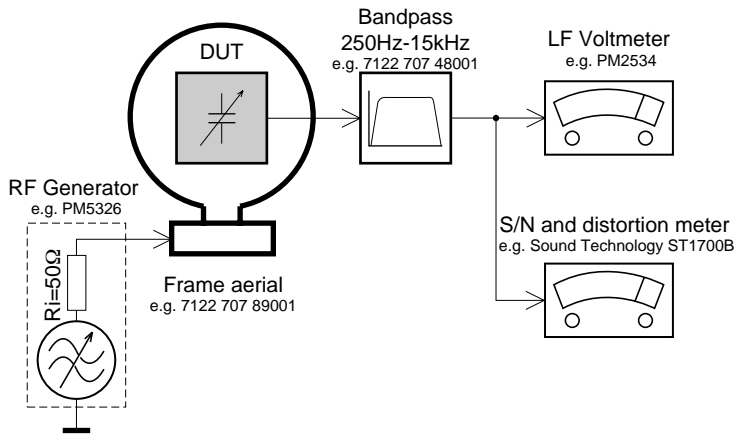

To avoid atmospheric interference all AM-measurements have to be carried out in a Faraday«s cage.

### CD

Use Audio Signal Disc SBC429 4822 397 30184 (replaces test disc 3)  
L.P.F. = 13<sup>th</sup> order filter 4822 395 30204

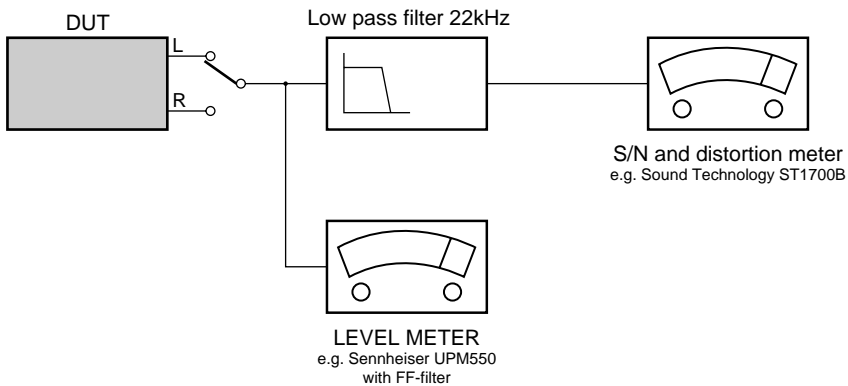

# CONNECTIONS AND CONTROLS

## CONTROLS

### TOP AND FRONT PANEL

- ① **LIFT TO OPEN** - to open the CD door.
- ② **Source selector** - POWER ON/OFF switch and to select source of sound source:  
**CD•MP3/MW/FM/TAPE(OFF)**.
- ③ **Cassette keys:**  
**PAUSE II** - to interrupt recording or playback.  
**STOP•OPEN ■ ▲** - To stop the tape and to open the cassette holder.  
**SEARCH ◀◀ or ▶▶** - to fast wind/rewind the tape.
- PLAY ◀** - to start playback.
- RECORD ●** - to start recording.
- ④ **PROG -**  
- to program disc tracks in CD/MP3 playback mode.  
- to set Point B for A-B playback in the language learning mode.
- ⑤ **LCD Display** - to show the MP3 functions and disc status.
- ⑥ **TUNING** - to tune to radio stations
- ⑦ **SEARCH ◀◀ or ▶▶**  
- to skip or search a passage or a track  
- In the language learning mode, to set Auto Loop, Follow, Compare, and adjust the number of sentence breaks.
- ⑧ **PLAY•PAUSE ▶▶**  
- to start or interrupt CD playback  
- to clear recorded contents in language learning mode
- ⑨ **ALBUM ▲/▼**  
- to select the desired album up or down in MP3 CD playback mode.  
- to adjust the repeat times in the language learning mode.
- ⑩ **STOP ■** - to stop playback
- ⑪ **MODE**  
- to select REPEAT, REPEAT ALL, SHUFFLE or SHUFFLE ALL in the music mode.  
- to toggle between LANGON and LANG OFF modes.  
- to toggle between AUTO and MANU in the language learning mode.

- ⑫ **LOOP** - to activate the LOOP language learning mode.
- ⑬ **MIC** - to input voice in the recording mode.
- ⑭ **FOLLOW** - to activate the FOLLOW language learning mode.
- ⑮ **COMPARE** - to activate the COMPARE language learning mode
- ⑯ **SPEED + / -** - to select the desired playing speed in the language learning mode.
- ⑰ **VOLUME** - to adjust volume level.

### BACK PANEL

- ⑱ **Telescopic aerial** - to improve FM radio reception  
Note: The speakers will be muted when the headphones are connected to the set.
- ⑲ **Battery door** - to open the battery compartment
- ⑳ **AC MAINS ~** - socket for mains lead
- Voltage selector (inside battery compartment, some versions only)** - Adjust to match the local voltage 110/220V before plugging in the set

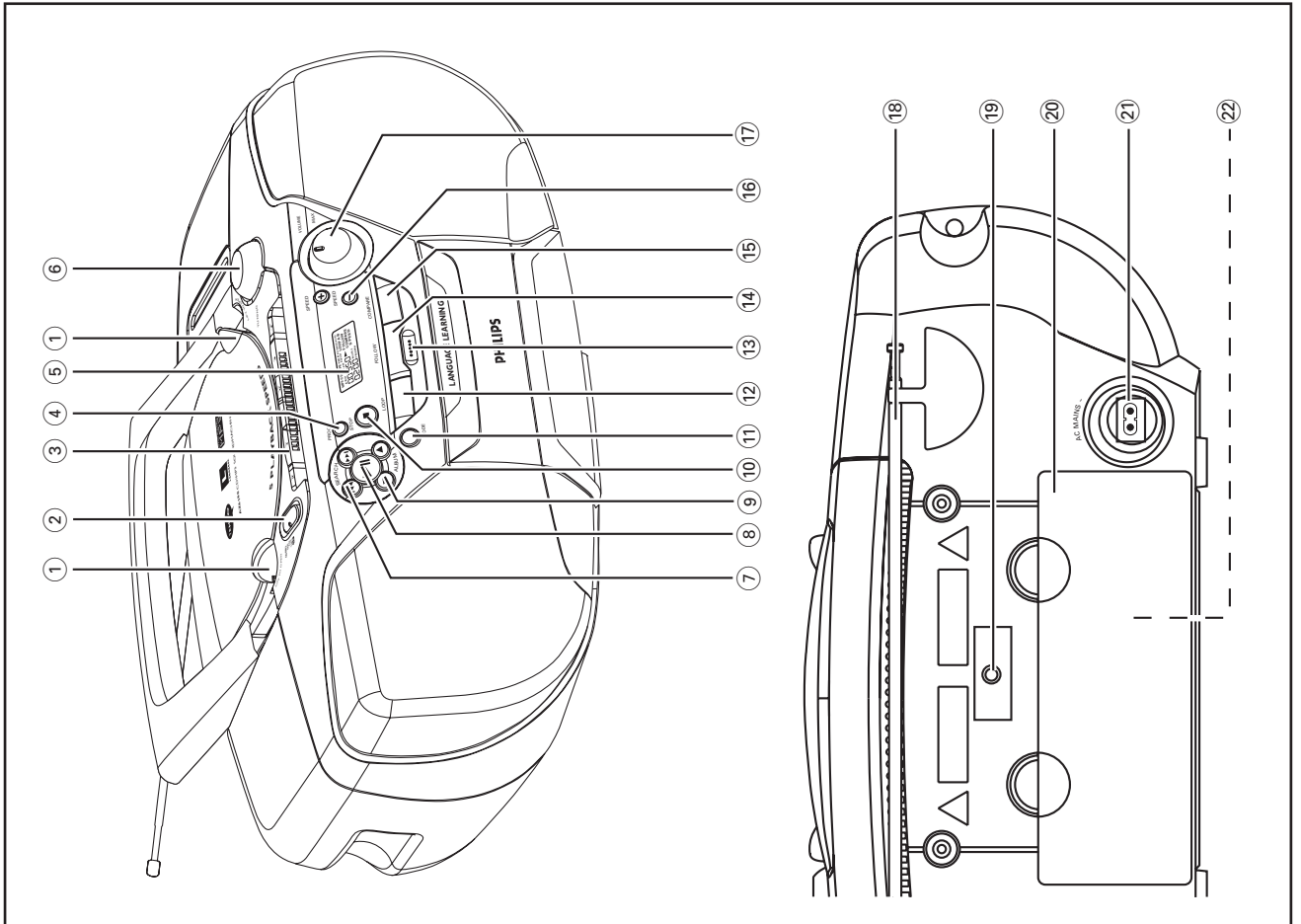

## INSTRUCTIONS FOR USE

## POWER SUPPLY

**BATTERIES (NOT SUPPLIED)**

Whenever convenient, use the mains supply if you want to conserve battery life. The battery supply will be switched off when the set is connected to the mains. Make sure you remove the plug from the set and wall outlet before inserting batteries.

**Batteries**

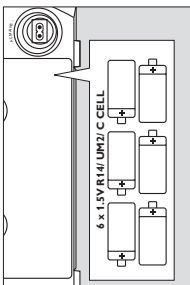
1. Open the battery compartment and insert six batteries, type **R14, UM2** or **C-cells**, (**preferably alkaline**) with the correct polarity as indicated by the "+" and "-" symbols inside the compartment.
 
  2. Replace the compartment door, making sure the batteries are firmly and correctly in place.
  3. Remove the batteries if they are exhausted or if they will not be used for a long period.
    - Incorrect use of batteries can cause electrolyte leakage and will corrode the compartment or cause the batteries to burst. Therefore:
    - Do not mix battery types, e.g. alkaline with zinc carbonate.
    - When inserting new batteries, replace all at the same time.
- Notes :**
- The battery supply is switched off when the set is connected to the mains.

**Batteries contain chemical substances, so they should be disposed of properly.**

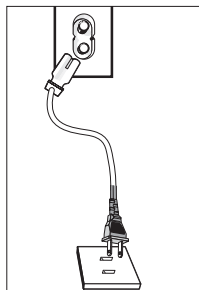
**MAINS**

1. Check if the mains voltage as shown on the type plate (on the bottom of the set) matches your local mains voltage. If it does not, consult your dealer or service organization.
2. If your set is equipped with a voltage selector, adjust the selector so that it matches with the local power supply.
3. Connect the mains lead to the **AC MAINS ~** socket and the wall socket.

The set is now ready for use.

4. To switch off the mains supply completely, pull the mains plug out of the wall socket. Disconnect the mains lead when you change over to battery supply, or to protect the set during heavy thunderstorms.

**The type plate is located on the bottom of the set.**

## TUNER OPERATION

**GENERAL OPERATION**

1. To switch on the set, adjust the source selector.
2. Adjust the sound using the **VOLUME** control.
3. To switch off the set, adjust the source selector to the **TAPE/OFF** position, with the cassette keys released.

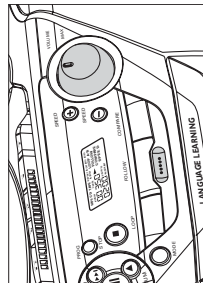
**RADIO RECEPTION**

1. Set the source selector to **FM** or **MW**.
2. Adjust the sound using the **VOLUME** control.
3. Tune to a radio station using the **TUNING** knob.
  - For FM, pull out the telescopic aerial. To improve FM-reception, incline and turn the aerial. Reduce its length if the FM-signal is too strong.
  - For MW, the set is provided with a built-in aerial, so the telescopic aerial is not needed. Direct the aerial by turning the whole set.
4. To switch off, set the source selector to the **TAPE/OFF** position (with the cassette keys released).

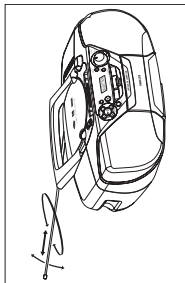
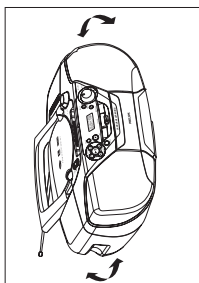

## INSTRUCTIONS FOR USE

## CD/MP3-CD

**CAUTION**

**Use of controls or adjustments or performance of procedures other than herein described may result in hazardous radiation exposure or other unsafe operation.**

**Environmental information**

Any unnecessary packaging material has been omitted. We have done our utmost to make the packaging easily separable into three mono materials: cardboard, polystyrene and plastic.

**Your set consists of materials which can be recycled if disassembled by a specialized company. Please observe the local regulations regarding the disposal of packaging materials, exhausted batteries and old equipment.**

**DISCS FOR PLAYBACK**

This set can play all digital audio CD, finalised digital audio CD-Recordable (CD-R) discs and finalised digital audio CD-Rewritable (CDRW) discs.

**Following MP3-CD formats are supported:**

- ISO 9660 or ISO 9660 + Joliet format - Max. 30 characters
- Max. Track number is 400
- Max. nested directory is 8 levels
- The max. album number is 99
- The max. MP3 programme track number is 20
- The max. length of each track is 99 minutes 59 seconds
- The player can play mixed mode disc of CD / MP3-CD
- Supported VBR bit-rate
- Supported sampling frequencies for MP3 disc : 8 kHz to 48 kHz (44.1kHz preferably)
- Supported bit-rates of MP3 disc are: 32 - 320 kbps (128 kbps preferably)

**Following formats are not supported**

- The files like \*.WMA, \*.AAC, \*.DLF, \*.M3U, \*.PLS, MP3 PRO
- Non-session closed discs



## CD/MP3-CD

**For MP3-CD only**

Playback starts from the first track of the first album. The MP3 icon album number and the elapsed playing time of the track are displayed.

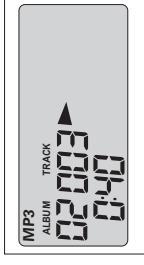

**Notes :-** To ensure good system performance, wait until the disc is completely read before proceeding.

- For MP3-CD, the disc reading time may exceed 1 minute due to the large number of songs compiled in one disc.

**PLAYING A NORMAL DISC**

1. Press **▶||** to start playback.

The current track number and **▶** appear on the display.

- To interrupt playback, press **▶||**.
- **▶** and the current track number will appear; the elapsed playing time will flashing.
- To resume playback, press **▶||** again.
- To stop playback, press **■**.

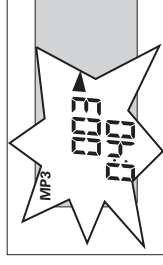
**SELECTING A DESIRED TRACK/PASSAGE****To select a desired track**

- Press **SEARCH** **◀◀** or **▶▶** repeatedly until the desired track appears on the display.
- If playback is stopped, press **▶||** to resume playback.

**To search for a particular passage during playback**

- Press and hold **SEARCH** **◀◀** or **▶▶** until you reach the beginning of your desired passage

**For MP3-CD only****To select a desired album**

- Press **ALBUM** **▲** or **▼** until the desired album number appears on the display.

**To select a desired track**

- Press **SEARCH** **◀◀** or **▶▶** repeatedly to select a desired track from the current album.

**To select and play another track during playback**

1. Press **SEARCH** **◀◀** or **▶▶** repeatedly to select another track.

The selected track will appear on the display and playback continues.

**LOADING A DISC**

1. Set the source selector to **CD**.
2. Lift to open the CD door.  
"OPEN" will be displayed
3. Insert a disc with the label side facing up.
4. Close the CD door.

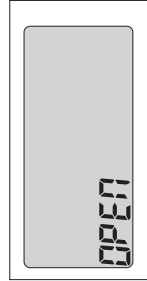

Playback starts from the first track.

The number and elapsed playing time of the first track are displayed.

"no disc" will be displayed if no disc is inserted or any error occurs in CD operation.

Playback starts from the first track of the first album.

The MP3 icon album number and the elapsed playing time of the track are displayed.

**Notes :-** To ensure good system performance, wait until the disc is completely read before proceeding.

- For MP3-CD, the disc reading time may exceed 1 minute due to the large number of songs compiled in one disc.

**PLAYING A NORMAL DISC**

1. Press **▶||** to start playback.

The current track number and **▶** appear on the display.

- To interrupt playback, press **▶||**.
- **▶** and the current track number will appear; the elapsed playing time will flashing.
- To resume playback, press **▶||** again.
- To stop playback, press **■**.

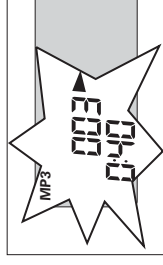
**SELECTING A DESIRED TRACK/PASSAGE****To select a desired track**

- Press **SEARCH** **◀◀** or **▶▶** repeatedly until the desired track appears on the display.
- If playback is stopped, press **▶||** to resume playback.

**To search for a particular passage during playback**

- Press and hold **SEARCH** **◀◀** or **▶▶** until you reach the beginning of your desired passage

**For MP3-CD only****To select a desired album**

- Press **ALBUM** **▲** or **▼** until the desired album number appears on the display.

**To select a desired track**

- Press **SEARCH** **◀◀** or **▶▶** repeatedly to select a desired track from the current album.

**To select and play another track during playback**

1. Press **SEARCH** **◀◀** or **▶▶** repeatedly to select another track.

The selected track will appear on the display and playback continues.

## INSTRUCTIONS FOR USE

## CD/MP3-CD

**PROGRAMMING TRACKS**

Programming tracks of disc is possible when playback is stopped. Up to 20 tracks can be stored in the memory in any order.

1. Press **■** to stop playback.
2. Press **SEARCH** **◀** or **▶** to select the desired track, or for MP3-CD playback press **ALBUM** **▲** / **▼** to select the desired album.
3. Press **PROG** to store the select track. " : : " represents the track number.
  - Repeat steps **1** to **3** to store other tracks.
4. Press **■** to end programme setting.
  - PROGRAM** will remain on the display.
  - You can press **◀** or **▶** to view the programmed tracks.
5. Press **▶||** to play the programmed tracks.
  - If you press **MODE** during program playback to activate **REPEAT** or **REPEAT ALL** function. **REPEAT/REPEAT ALL** icon and **PROGRAM** will appear on the display.
6. Press twice to clear the programme.
  - PROGRAM** will disappear from the display, and **ELERF** will appear, followed by the number of total tracks and the total playing time.

**Note:** - You can also press **PROG** to program tracks during normal playback

**MODE****REPEAT**

1. In the playback, pause or stop mode, press **MODE** to enable the **REPEAT** play function.
  - REPEAT** - to repeat the current track.
  - REPEAT ALL** - to repeat the whole disc
  - REPEAT ALBUM** - to repeat the current album.
2. To exit the repeat mode, press **MODE** until the **REPEAT/REPEAT ALL** icon disappears.

**Notes :** - The Shuffle and Repeat play modes cannot be combined for playback.  
- The Repeat play mode is cancelled when you press the **STOP** button.

**SHUFFLE**

You can play all the tracks in a random order.

1. In the playback, pause or stop mode, press **MODE** to enable the **SHUFFLE** function. **SHUFFLE** will appear on the display.
2. To exit the shuffle mode, press **■** or **MODE** until **SHUFFLE/SHUFFLE ALL** disappears.

## LANGUAGE LEARNING

This set features language learning functions based on CD, MP3-CD and tape playback modes. To select your desired playback source, please adjust the source selector to TAPE, FM, MW or CD-PM3.

**MUSIC MODE AND LANGUAGE LEARNING MODE**

When the set is start for the first time, the set is in the music mode. In this case, you can play CD, MP3-CD or tape.

**Note :** - CD playback is not in the compressed playback mode, therefore the sound quality is not affected, but the language learning function is not activated.

- Press and hold **MODE**, and **LANG ON** and **MANU** are displayed. The language learning function is activated.

**Notes :** - In the language learning mode, you can press **MODE** to toggle between manual and auto.  
- To provide the 120-second repeat function in the CD playback mode, all the data in the CD will be first compressed and stored in the SD RAM for subsequent playback, therefore the sound quality might be slightly affected.

- Once in the language learning mode, **LANG ON** will disappear and **MANU** will remain flashing.

- Press and hold **MODE** again and **LANG OFF** is displayed. The language learning function is deactivated. Both **LANG ON** and **MANU** disappear.

**STORE THE CONTENTS PLAYED, AND START MANUAL LOOP, FOLLOW OR COMPARE (LOOP, FOLLOW, COMPARE)**

In the language learning mode, the contents played will be automatically stored in a Synchronous Dynamic Random Access Memory (SD RAM).

The storage periods are different according to different playback sources:

Playback source	Storage period
Tape	440 seconds
CD	120 seconds
MP3 128bpc	440 seconds

**Notes :** - For MP3-CDs of different bit rates, the storage periods may also be different. A smaller bit rate implies longer storage time. A greater bit rate implies shorter storage time. (64bps = 960 seconds, 320bps = 240 seconds).  
- When the SD RAM is full, the latest contents will overwrite the older data in the principle of "First-in and first-out".

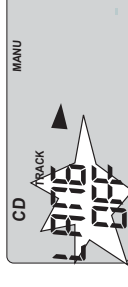
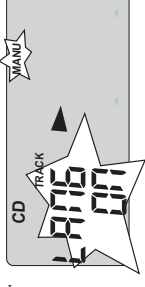



## INSTRUCTIONS FOR USE

### LANGUAGE LEARNING

- Press **LOOP**, **FOLLOW** or **COMPARE** to start the manual loop, follow or compare mode for the contents stored.

#### HOW TO SELECT A PASSAGE FOR LANGUAGE LEARNING?

In CD or MP3-CD mode, when a track (or a text) has started, Press and hold **SEARCH** **◀◀** or **SEARCH** **▶▶** to go to the beginning of your desired track and then release the button; **OR**

- Wait until playback goes to the beginning of your desired track, and press **PLAY/PAUSE** **▶||** to interrupt the playback, and then release this button to continue playback.

In this case, the set will clear all contents in its SD RAM and start recording the contents to be used for language learning.

**Note** : - After a new track (or text) is played, the set will automatically clear the old contents and start recording from the current playing time. This is to avoid interference between two tracks (or two texts).

- At the end of your desired track, press **LOOP**, **FOLLOW** or **COMPARE** to activate manual **LOOP**, **FOLLOW** or **COMPARE** mode.

In the tape playback mode, Press **PLAY** **▶** and the set will record the contents being played automatically.

- During tape playback, press **PLAY/PAUSE** **▶||**.

The contents previously stored will be cleared and the set starts to record new contents.

Therefore, if you want to select a passage for language learning, you can operate as per the following steps:

1. Stop tape playback (press **■**), and then press **SEARCH** **◀◀** or **SEARCH** **▶▶** to go to the beginning of your desired passage. Release the key and then press **PLAY** **▶**.  
The set automatically starts to record the contents being played.
2. Press **PLAY/PAUSE** **▶||** at the beginning of your desired track.  
The set clears the contents previously stored and starts to record new contents being played automatically.
3. At the end of your desired passage, press **LOOP**, **FOLLOW** or **COMPARE** to start manual Loop, Follow and Compare.

#### MANUAL LOOP

- In the language learning mode, press **LOOP** to start manual loop **LOOP** appears on the display.

The set will repeat the contents recorded and stored in the SD RAM. The repeat times is set as 3 by default

### LANGUAGE LEARNING

After three times, the set will resume to the normal playback mode and the next passage will be played and recorded in the SD RAM.

- During manual loop, you can press **ALBUM** **▲** / **▼** to change the repeat times (3 times by default and 9 times at most).  
r9 is displayed.
- During manual loop, you can press **PLAY/PAUSE** **▶||**.  
The repeat stops. The next passage will be played normally.
- During manual loop, you can press **LOOP** to repeat the current passage (at the set repeat times).
- Press **FOLLOW** or **COMPARE** to activate the language learning function for the current passage.

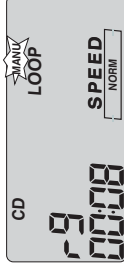

Language Learning in **A-B** mode

During manual loop, you can set Point A and Point B and repeat the contents between the two points.

#### How to set A-B mode?

##### SET POINT A

- Press and hold **SEARCH** **◀◀** or **SEARCH** **▶▶** to go to the beginning of your desired passage, and release the button. This stop point is Point A.  
The icon **A-B** blinks on the display.
- When playback goes to the end of your desired passage, press **PROG**.

##### This point is Point B.

After **A-B** is set, the contents between Point A and Point B will be played repeatedly.

##### Repeat Times

- The number of repeat times is the value manually set previously.
- After the last repeat, the system will quit the **A-B** mode and the manual repeat mode. Normal playback then starts from the next passage. The contents played are recorded in the SD RAM synchronously.

**Notes** : - During **A-B** playback, you can press **ALBUM** **▲** / **▼** to change the repeat times (3 times by default and 9 times at most).

- During **A-B** playback, you can press **PLAY/PAUSE** **▶||** to interrupt **A-B** mode and quit the manual repeat mode, and start the next passage at the same time.
- During **A-B** playback, you can press **LOOP** to quit **A-B** mode to repeat the whole passage (at the repeat times previously set); You can also press **FOLLOW** or **COMPARE** to quit **A-B** mode to start follow or compare for the current passage.

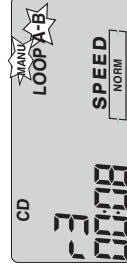

## INSTRUCTIONS FOR USE

## LANGUAGE LEARNING

## AUTO LOOP

- In the manual Loop mode, you can press **MODE** to start Auto Loop. **AUTO** flashes on the display.

**Notes:** - The current manual repeat will stop and will detect the sentence intervals from the next passage for automatic sentence break, and repeat one sentence or several sentences automatically.

- In the Auto Loop mode (during normal playback or repeat), you can press **SEARCH** **◀** or **SEARCH** **▶** to change the number of sentence breaks (1 by default or 9 at most).
- You can press **ALBUM** **▲** / **▼** to change the repeat times.
- During Auto Loop, you can press **PLAY/PAUSE** **▶** to skip from the current passage to the next passage, OR
- Press **LOOP** to repeat the current passage (at the times previously set), OR
- Press **FOLLOW** or **COMPARE** to start Follow or Compare for the current passage, and enter the Auto Follow or Auto Compare mode.
- During normal playback in the Auto Loop mode, you can press **FOLLOW** or **COMPARE** to activate Auto Follow or Auto Compare.
- In the Auto Loop mode, you cannot activate the A-B language learning function



## LANGUAGE LEARNING

## AUTO FOLLOW

- In the manual Follow mode, press **MODE** to switch to auto follow from manual follow. **AUTO** flashes on the display.

- Notes:** - The set will quit the ongoing manual follow and start from the next passage to detect the interval between sentences during playback, so that one or several sentences will be repeated in the auto follow mode.
- During auto follow (during normal playback or follow), you can press **SEARCH** **◀** or **SEARCH** **▶** to change the number of sentence breaks (1 by default or 9 at most).
  - Press **ALBUM** **▲** / **▼** to change the repeat times.
  - During auto follow, you can press **PLAY/PAUSE** **▶** to skip to the next passage to start the normal playback of the next passage and break sentences automatically.
  - You can press **LOOP** to repeat the contents of the current passage (at the times previously set).
  - Or press **FOLLOW** or **COMPARE** to repeat the contents of the current passage in the follow or compare mode, and activate auto follow or compare functions.
  - During normal playback in the auto follow mode, you can press **LOOP** or **COMPARE** to switch to the auto loop or auto compare mode.
  - In the Auto Follow mode, you cannot activate the A-B language learning function.



## MANUAL FOLLOW

In the language learning mode, you can press **FOLLOW** to start Manual Follow.

**FOLLOW** appears on the display.

The set will play the recorded content for 1 time and then start recording.

Playback and recording can be repeated (for 1 time by default).

After 1 time of follow, the set will start normal playback automatically.



- Notes:** - The recording time equals the playback time. The whole process (playback + recording) will be repeated at the time previously set.
- After recording, normal playback will start from the next passage and will be recorded into the SD RAM automatically.
  - During playback and recording, you can press **ALBUM** **▲** / **▼** to change the repeat times (1 time by default or 9 at most).
  - During Follow and recording, you can press **PLAY/PAUSE** **▶** to quit Follow and start the normal playback of the next passage.
  - You can also press **LOOP** or **COMPARE** to quit the Follow mode and start Loop or Compare for the current passage.

## A-B FOLLOW

Please refer to the **A-B** repeat operation procedure for the CD or Tape Loop mode.

## MANUAL COMPARE

- In the language learning mode, press **COMPARE** to enter the manual compare mode.

**COMPARE** appears on the display.

The set will play the recorded content for 1 time and then start recording.

Playback and recording can be repeated (for 1 time by default).

After 1 time of compare playback, the set will start normal playback automatically.



- Notes:** - The recording time equals the playback time.
- After recording, the original sound will be repeated once, followed by the recorded sound. The compare process (repeated playback + playback of original sound) will repeat at the times already set.
  - Once the normal playback is resumed, the next passage will start and will be recorded in the SD RAM synchronously.
  - During manual compare playback, recording, playback or repeated playback, you can press **ALBUM** **▲** / **▼** to change the repeat times (1 time by default and 9 times at most).
  - During manual compare playback, recording, playback or repeated playback, you can press **PLAY/PAUSE** **▶** to exit the compare playback mode and play the next passage normally.
  - Or you can press **COMPARE** to repeat the compare playback for the ongoing passage (at the times already set).
  - You can press **LOOP** or **FOLLOW** to start the loop or follow for the current passage.

## INSTRUCTIONS FOR USE

## LANGUAGE LEARNING

**A-B COMPARE**

Please refer to the **A-B** repeat operation procedure for the CD or Tape Loop mode.

**AUTO COMPARE**

- In the manual compare mode, press **MODE** to start Auto compare.

**AUTO** flashes on the display.

The set will quit the ongoing manual compare and start from the next passage to detect the interval between sentences during playback, so that one or several sentences will be repeated in the auto compare mode.

During auto compare (during normal playback or compare), you can press **SEARCH** **◀◀** or **SEARCH** **▶▶** to change the number of sentence breaks (1 by default or 9 at most).

Press **ALBUM** **▲** / **▼** to change the repeat times.

During auto compare, recording, repeated playback or recorded sound playback, you can press **PLAY/PAUSE** **▶** to skip to the next passage to start the normal playback of the next passage and break sentences automatically.

You can press **COMPARE** to repeat the contents of the current passage (at the times already set).

Or press **LOOP** or **FOLLOW** to repeat the contents of the current passage in the loop or follow mode, and activate auto loop or compare functions.

During auto compare mode, you can press **LOOP** or **FOLLOW** to switch to the auto loop or auto follow mode.

**CHANGING PLAYBACK SPEED**

In any language learning mode, you can press **SPEED+/-** to change the playback speed. Five speeds are available: 0.5x, 0.75x, normal, 1.25x and 1.5x.

**Note** : - This feature is not available in the music playback mode.

## LANGUAGE LEARNING

**A-B COMPARE**

Please refer to the **A-B** repeat operation procedure for the CD or Tape Loop mode.

**AUTO COMPARE**

- In the manual compare mode, press **MODE** to start Auto compare.

**AUTO** flashes on the display.

The set will quit the ongoing manual compare and start from the next passage to detect the interval between sentences during playback, so that one or several sentences will be repeated in the auto compare mode.

During auto compare (during normal playback or compare), you can press **SEARCH** **◀◀** or **SEARCH** **▶▶** to change the number of sentence breaks (1 by default or 9 at most).

Press **ALBUM** **▲** / **▼** to change the repeat times.

During auto compare, recording, repeated playback or recorded sound playback, you can press **PLAY/PAUSE** **▶** to skip to the next passage to start the normal playback of the next passage and break sentences automatically.

You can press **COMPARE** to repeat the contents of the current passage (at the times already set).

Or press **LOOP** or **FOLLOW** to repeat the contents of the current passage in the loop or follow mode, and activate auto loop or compare functions.

During auto compare mode, you can press **LOOP** or **FOLLOW** to switch to the auto loop or auto follow mode.

**CHANGING PLAYBACK SPEED**

In any language learning mode, you can press **SPEED+/-** to change the playback speed. Five speeds are available: 0.5x, 0.75x, normal, 1.25x and 1.5x.

**Note** : - This feature is not available in the music playback mode.



## CASSETTE RECORDER

### RECORDING FROM THE RADIO

1. Set the source selector to **FM** or **MW**.
2. Tune to the desired radio station using the **TUNING** knob.
3. Press **STOP•OPEN** **▲** to open the cassette holder.
4. Insert a blank tape.
5. Press **RECORD** **●** to start recording.
6. For brief interruptions, press **PAUSE II**. To resume recording, press **PAUSE II** again.
7. To stop recording, press **STOP•OPEN** **▲**.

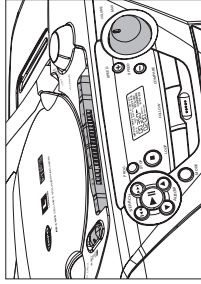

### SYNCHRO START CD RECORDING

1. Set the source selector to **CD•MP3**.
  2. Insert a CD and if desired, programme track numbers.
  3. Press **STOP•OPEN** **▲** to open the cassette holder.
  4. Insert a blank cassette.
  5. Press **RECORD** **●** to start recording.  
Playback starts automatically from the beginning of the programme. It is not necessary to start the CD player separately.
  6. For brief interruptions, press **PAUSE II**. To resume recording, press **PAUSE II** again.
  7. To stop recording, press **STOP•OPEN** **▲**.
- To select and record a particular passage within a track**
1. Press and hold **SEARCH** **◀◀** or **▶▶** to select a passage.
  2. Press **PLAY/PAUSE** **▶II**.  
Recording will start from this exact point when you press **RECORD** **●** and **PLAY** **◀**.

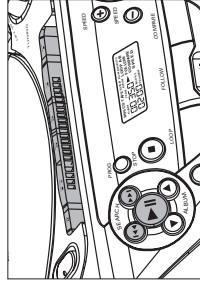

### INTERRUPT RECORDING SYNCHRONOUSLY

1. During recording from the CD/MP3 source, if playback is paused or stopped, tape recording will also paused automatically.
2. When you press **PLAY/PAUSE** **▶II** to resume playback, tape recording will also be resumed synchronously.

## INSTRUCTIONS FOR USE

## TROUBLESHOOTING

If a fault occurs, first check the points listed below before taking the set for repair. If you are unable to remedy a problem by following these hints, consult your dealer or service centre.

**WARNING: Do not open the set as there is a risk of electric shock. Under no circumstances should you try to repair the set yourself, as this will invalidate the guarantee.**

Problem	Solution
"E1 E1 E1" is displayed	<ul style="list-style-type: none"> <li>– Insert a disc and check if the disc is upside down.</li> <li>– Wait until the moisture condensation at the lens has cleared.</li> <li>– Replace or clean the disc, see "Maintenance"</li> <li>– Use a readable disc or an MP3-CD recorded in the correct format.</li> </ul>
Radio reception is poor	<ul style="list-style-type: none"> <li>– If the signal is too weak, adjust the antenna for better reception.</li> <li>– Increase the distance between the Receiver and your TV or VCR.</li> </ul>
Recording or playback cannot be made	<ul style="list-style-type: none"> <li>– Clean deck parts, see "Maintenance".</li> <li>– Use only <b>NORMAL</b> (IEC I) tape.</li> <li>– Apply a piece of adhesive tape over the missing tab space.</li> </ul>
The system does not react when the buttons are pressed /The set does not work / No display on LCD.	<ul style="list-style-type: none"> <li>– Slide the source selector to <b>TAPE/OFF</b>. Remove the AC power plug and reconnect it 30 seconds later and then switch on the system again.</li> <li>– Adjust the volume.</li> <li>– Make sure the MP3-CD was recorded within 32-320 kbps (128kbps preferably) with sampling frequencies at 8 - 48 kHz (44.1kHz preferably).</li> </ul>
Sound cannot be heard or is of poor quality	<ul style="list-style-type: none"> <li>– Check if the language learning mode is activated. Press Loop, Follow or Compare is not available and hold <b>MODE</b> until <b>LANG ON</b> appears on the display. Then the language learning is activated.</li> </ul>
Loop, Follow or Compare is not available	<ul style="list-style-type: none"> <li>– The CD disc may be scraped. Please replace the disc with a new one.</li> <li>– If in the tape mode, the tape quality may be poor. Please use a good tape.</li> </ul>
The set does not break sentences automatically	<ul style="list-style-type: none"> <li>– The playing speed can be changed only in the language learning mode.</li> <li>– Please activate Loop, Follow or Compare function in the language learning mode first.</li> </ul>
The playing speed cannot be changed	

## DISASSEMBLY DIAGRAM

## A. REMOVE FRONT CABINET ASSEMBLY

- REMOVE SCREWS A1 (3X20) 6 PCS
- REMOVE SCREW A2 (3X54) 1PS  
(IN BATTERY COMPONENT)

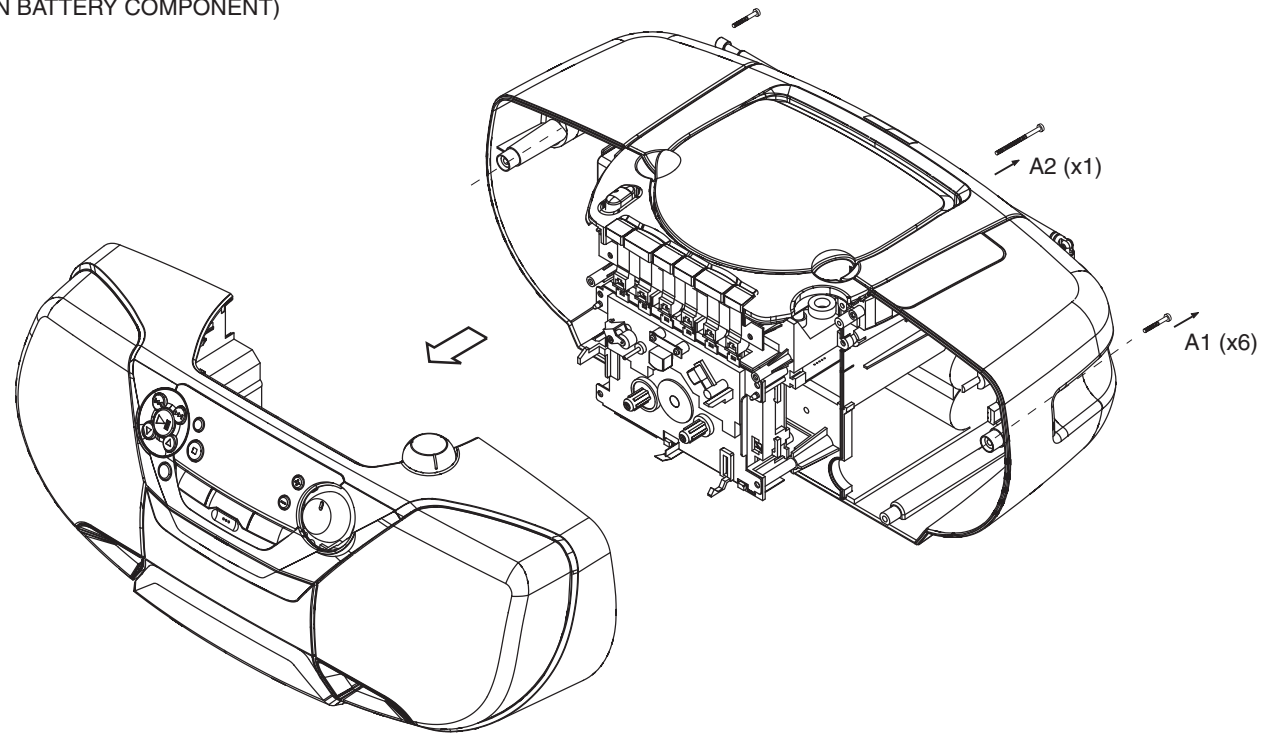

## B. REMOVE CD TRAY ASSEMBLY

- REMOVE SCREWS B3 (3X8) 2PCS
- REMOVE SCREWS B4 (3X8) 2PCS

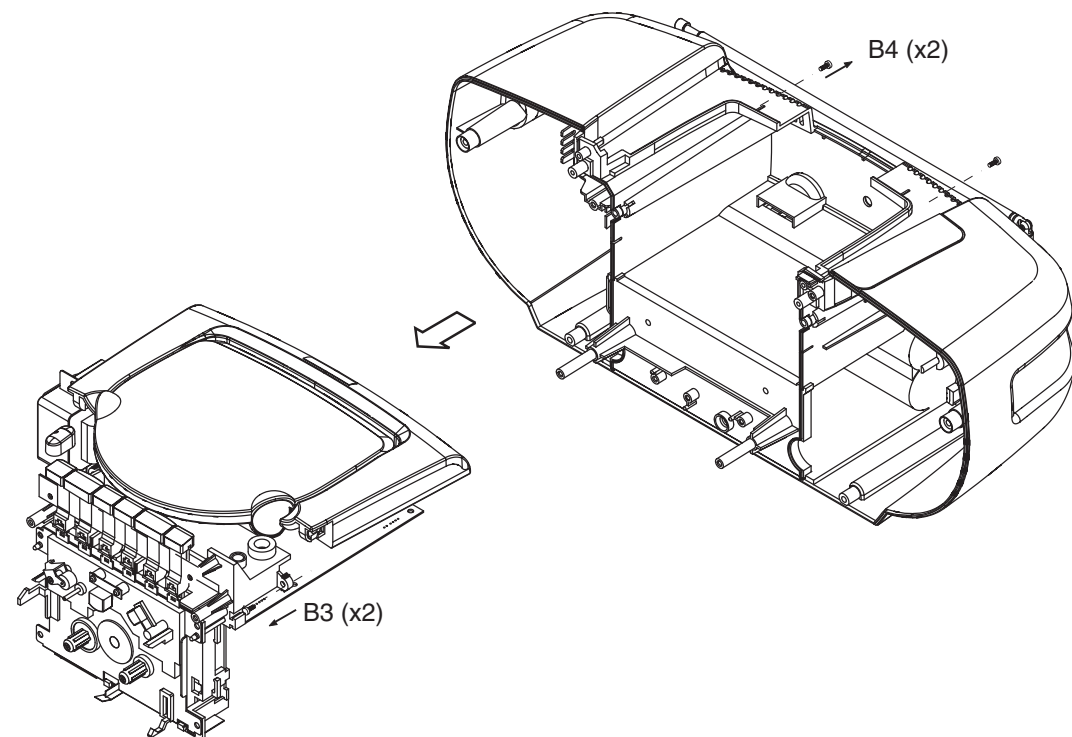

## C. REMOVE FRONT PANEL ASSY

- REMOVE SCREWS C5 (2.5X8) 4 PCS  
( BESIDE SPEAKER)
- RELEASE FRONT PANEL CATCH

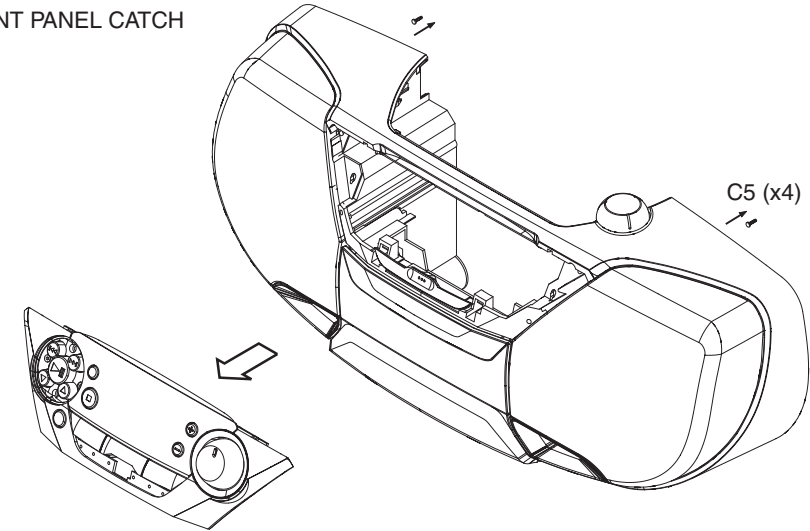

## D. REMOVE CD DECK MECHANISM

- REMOVE SCREWS D5 (3X10) 4 PCS
- REMOVE CASSETTE DECK
- REMOVE SCREWS D6 (3X12) 6 PCS
- REMOVE COMBI BOARD
- REMOVE SCREWS D7 (2.5X10) 4PCS
- REMOVE CD DECK MECHANISM

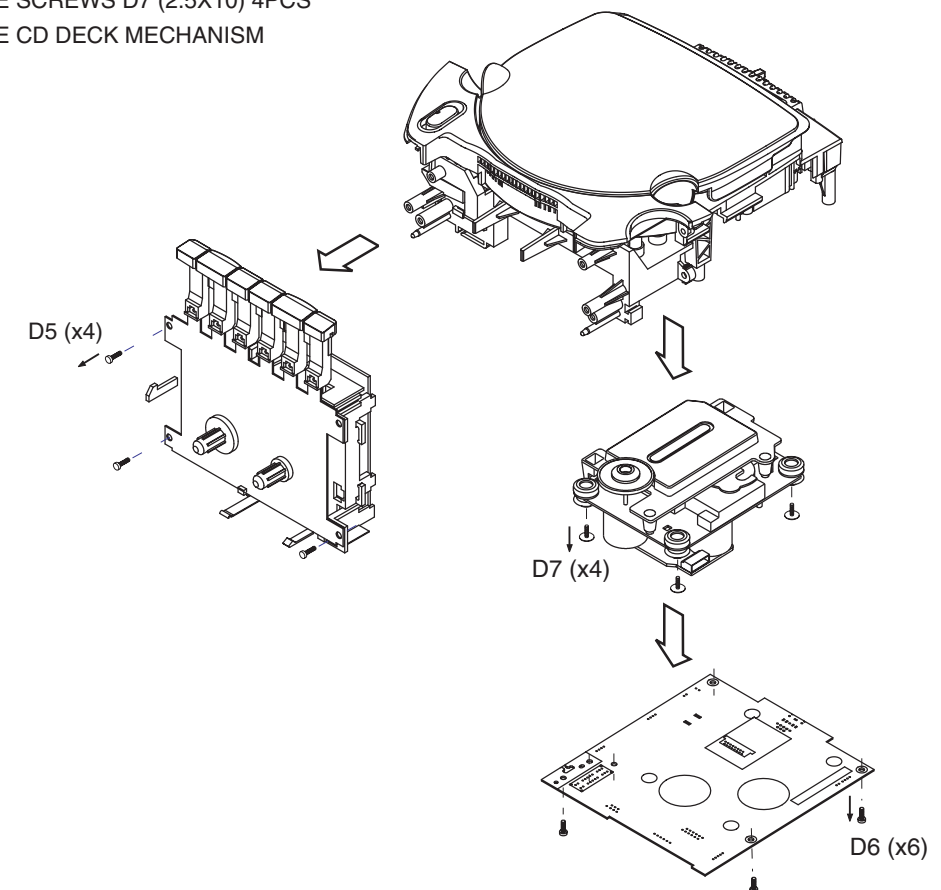

# BLOCK DIAGRAM

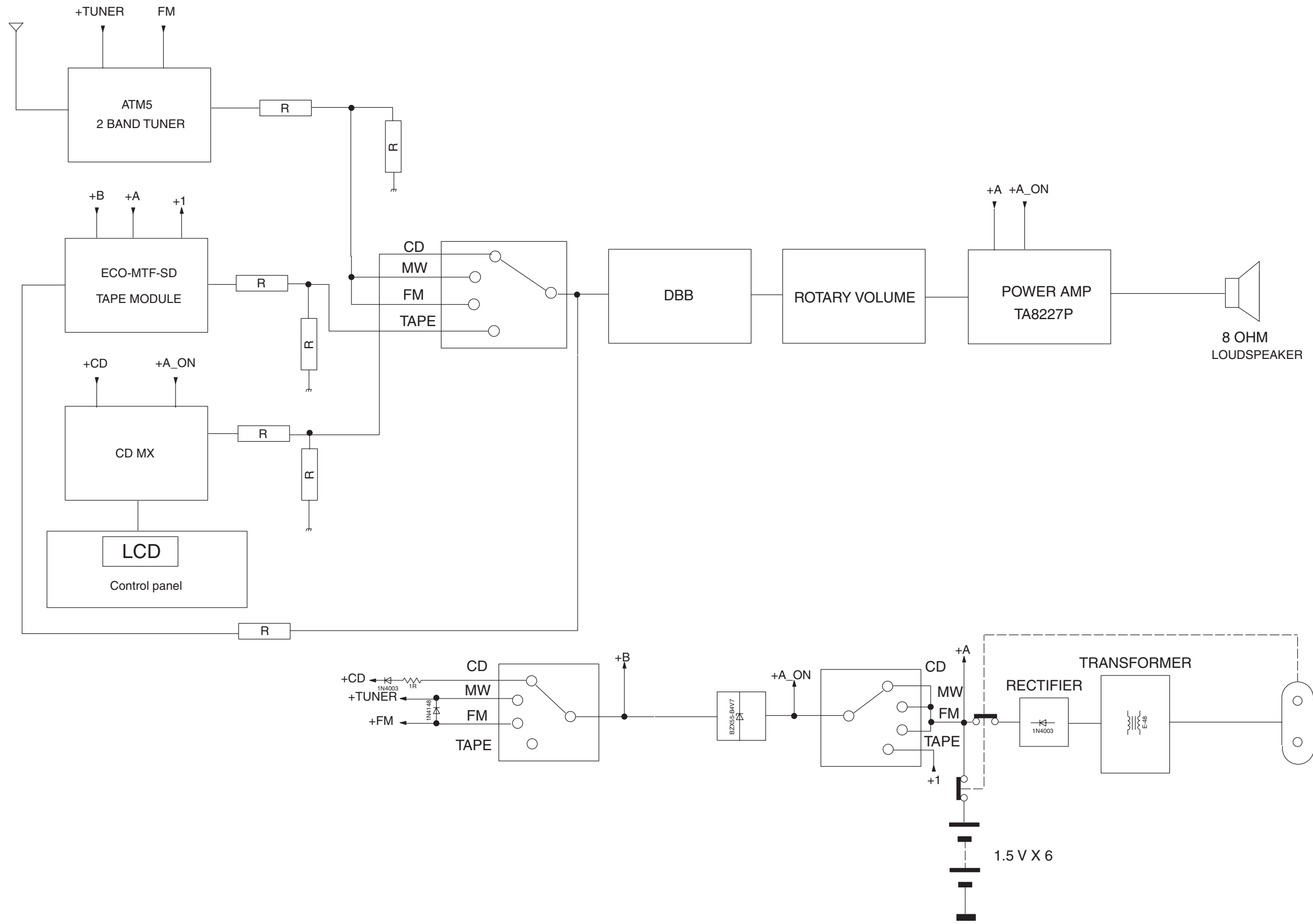

WIRING DIAGRAM

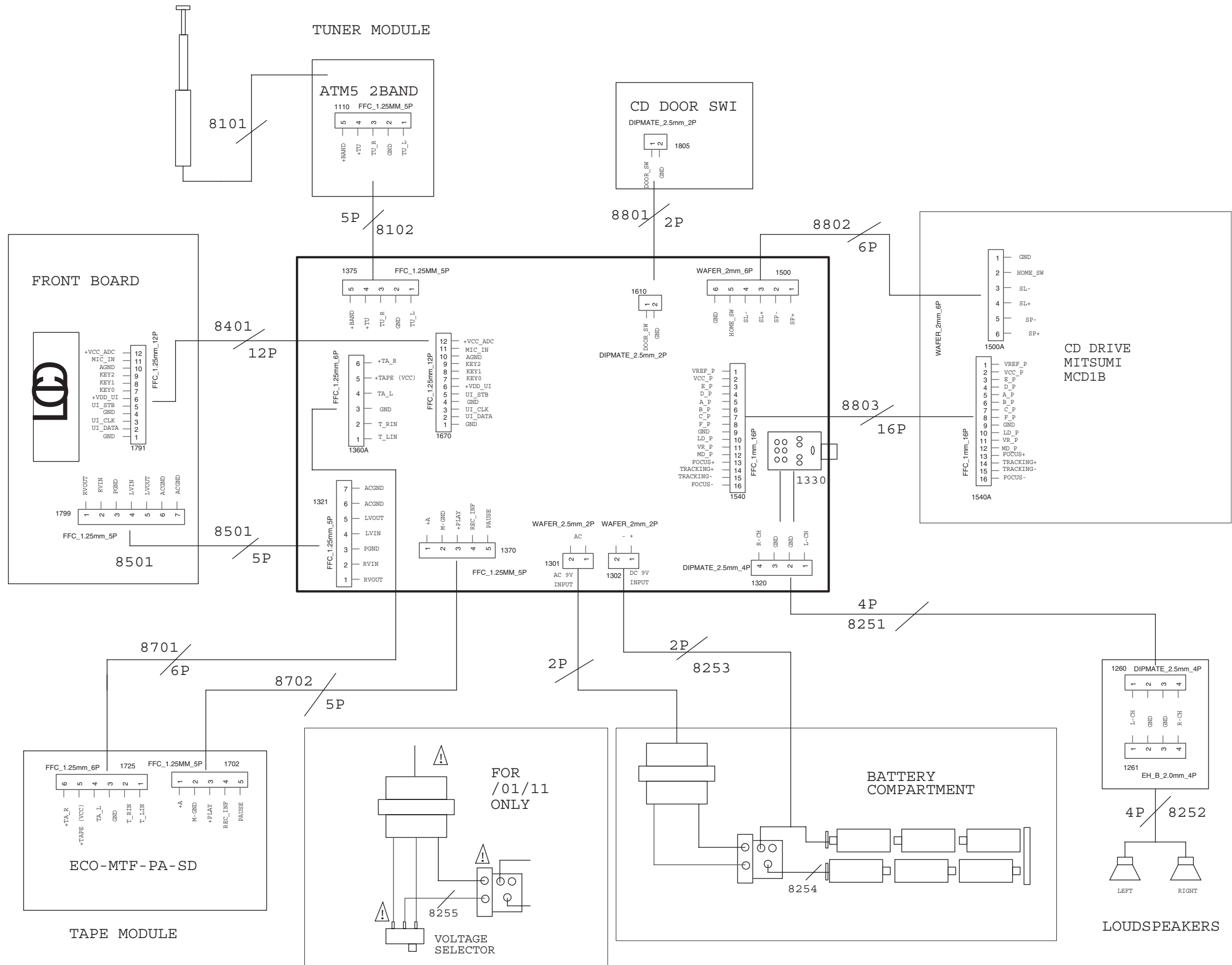

# FRONT BOARD - CIRCUIT DIAGRAM

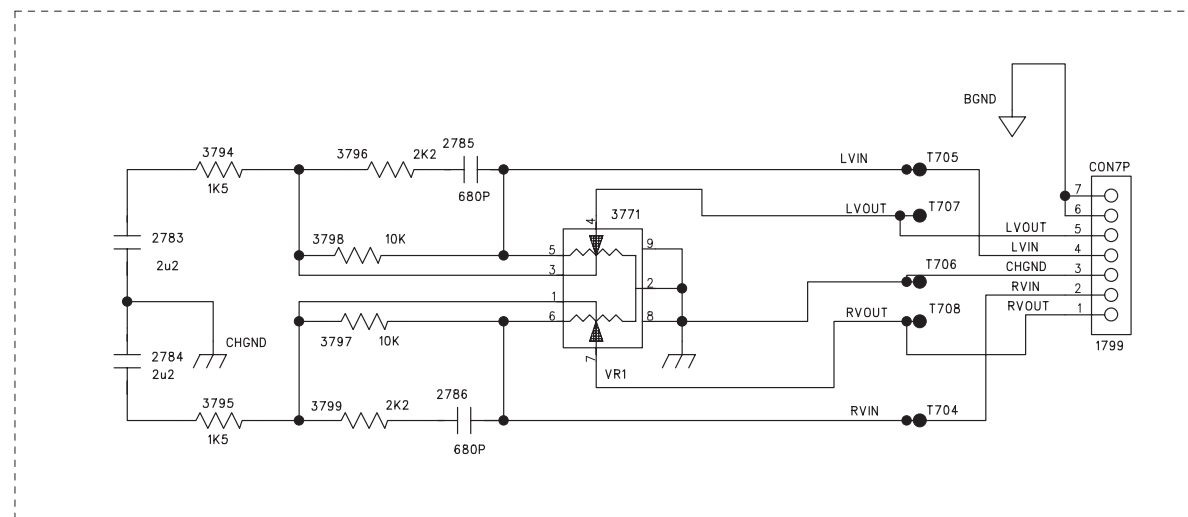
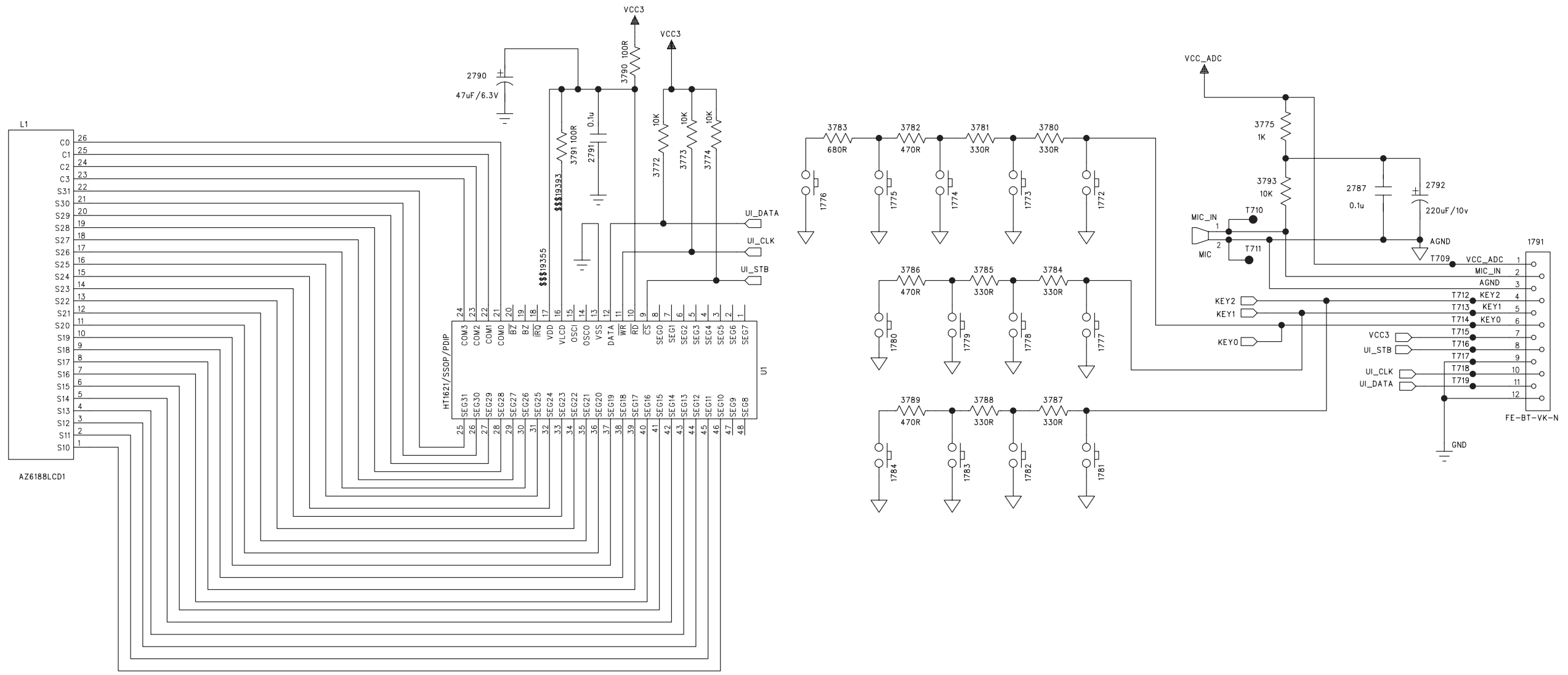



FRONT BOARD - LAYOUT DIAGRAM

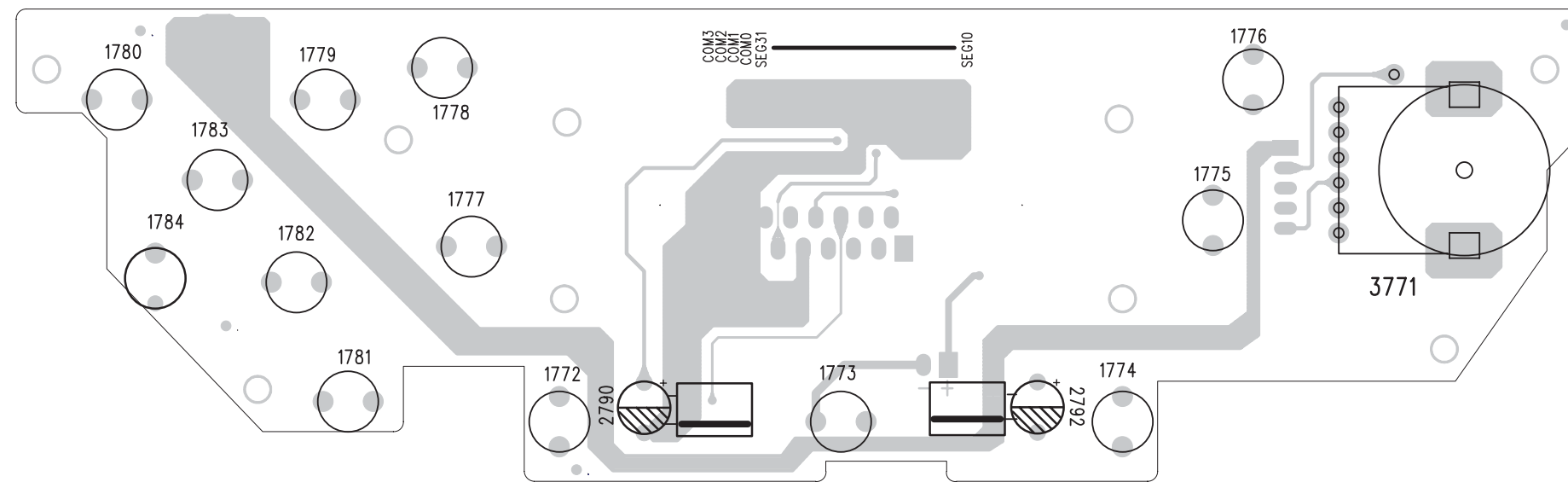
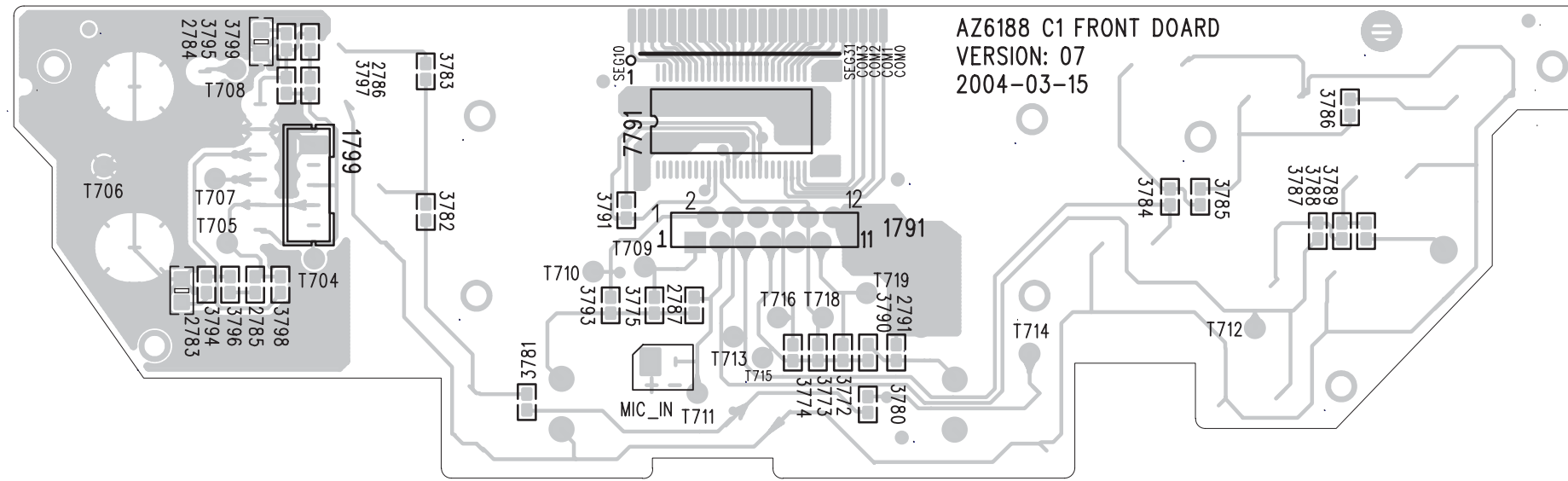

# TUNER BOARD ATMS - CIRCUIT DIAGRAM

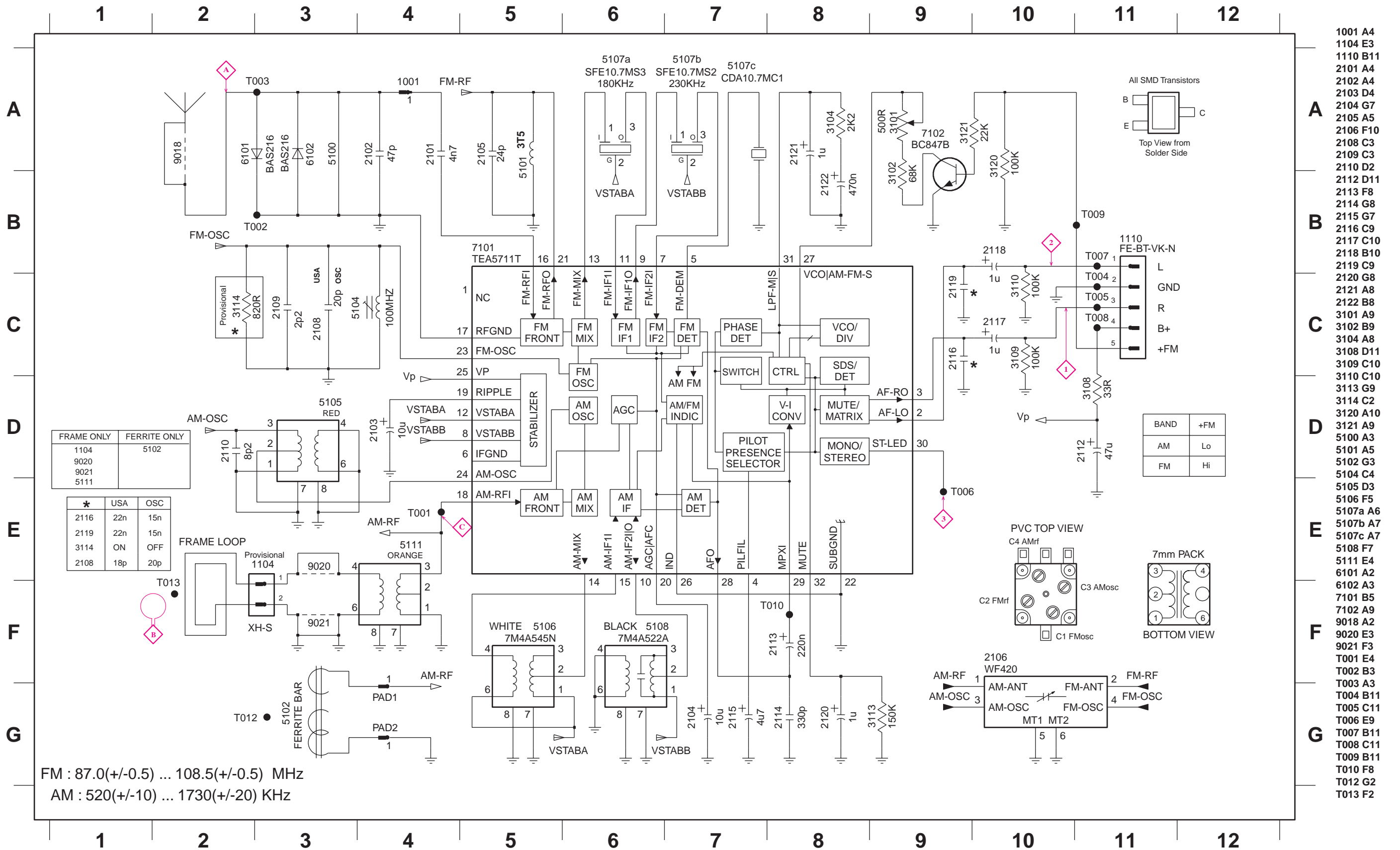

- 1001 A4
- 1104 E3
- 1110 B11
- 2101 A4
- 2102 A4
- 2103 D4
- 2104 G7
- 2105 A5
- 2106 F10
- 2108 C3
- 2109 C3
- 2110 D2
- 2112 D11
- 2113 F8
- 2114 G8
- 2115 G7
- 2116 C9
- 2117 C10
- 2118 B10
- 2119 C9
- 2120 G8
- 2121 A8
- 2122 B8
- 3101 A9
- 3102 B9
- 3104 A8
- 3108 D11
- 3109 C10
- 3110 C10
- 3113 G9
- 3114 C2
- 3120 A10
- 3121 A9
- 5100 A3
- 5101 A5
- 5102 G3
- 5104 C4
- 5105 D3
- 5106 F5
- 5107a A6
- 5107b A7
- 5107c A7
- 5108 F7
- 5111 E4
- 6101 A2
- 6102 A3
- 7101 B5
- 7102 A9
- 9018 A2
- 9020 E3
- 9021 F3
- T001 E4
- T002 B3
- T003 A3
- T004 B11
- T005 C11
- T006 E9
- T007 B11
- T008 C11
- T009 B11
- T010 F8
- T012 G2
- T013 F2

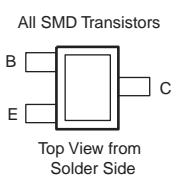

BAND	+FM
AM	Lo
FM	Hi

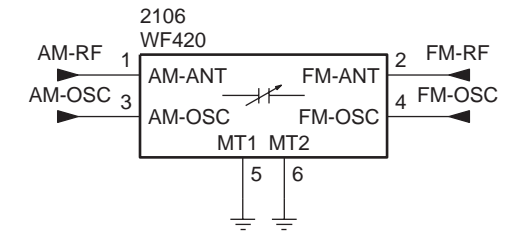
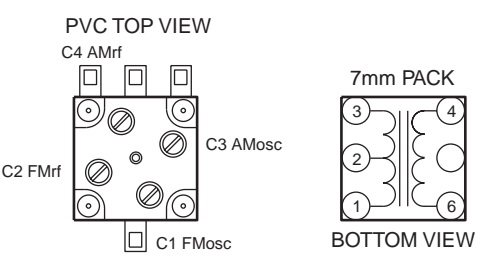

TUNER BOARD ATM5 - LAYOUT DIAGRAM

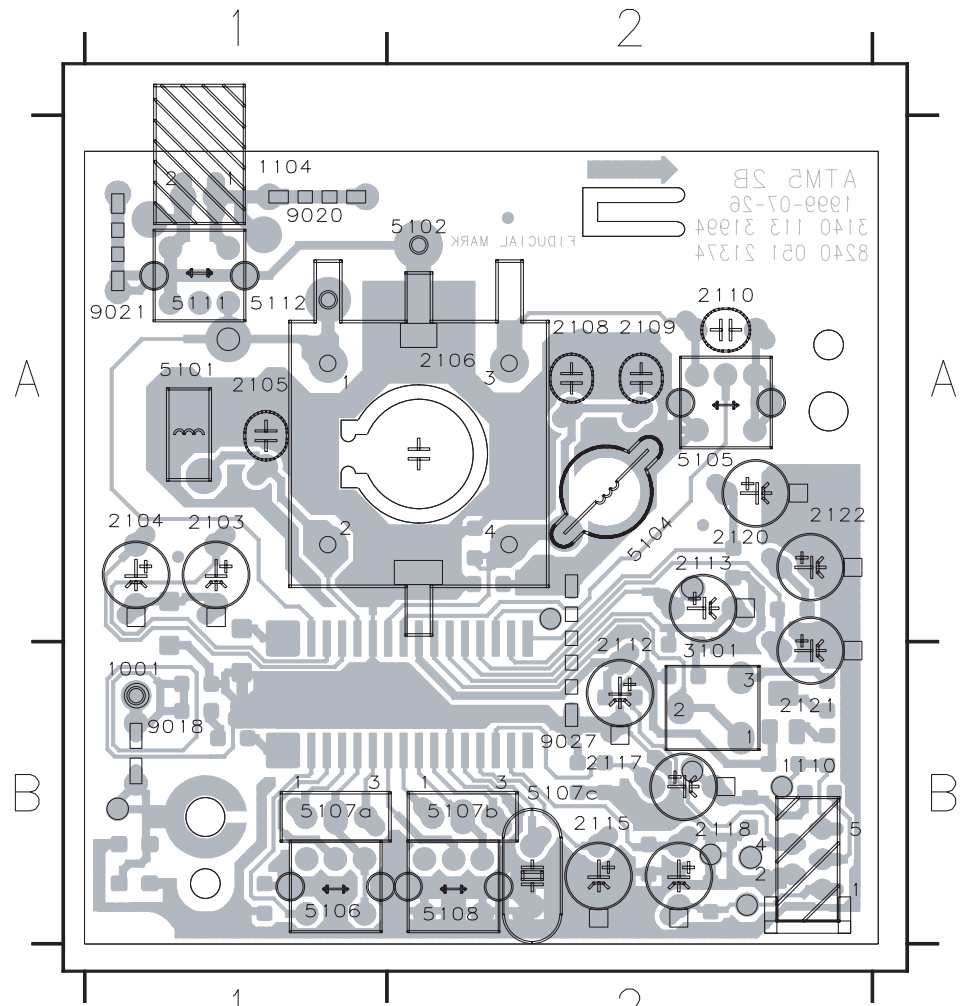

- 1001 E1
- 1104 A2
- 1110 F6
- 2103 D2
- 2104 D1
- 2105 C2
- 2106 C3
- 2108 B5
- 2109 B5
- 2110 B6
- 2112 E5
- 2113 D6
- 2115 F5
- 2117 F5
- 2118 G6
- 2120 C6
- 2121 E6
- 2122 D6
- 3101 E6
- 5101 C1
- 5102 B3
- 5104 D5
- 5105 C6
- 5106 G2
- 5107a F3
- 5107b F4
- 5107c F4
- 5108 G3
- 5111 B1
- 5112 B2
- 9018 F1
- 9020 A2
- 9021 A1
- 9027 D5

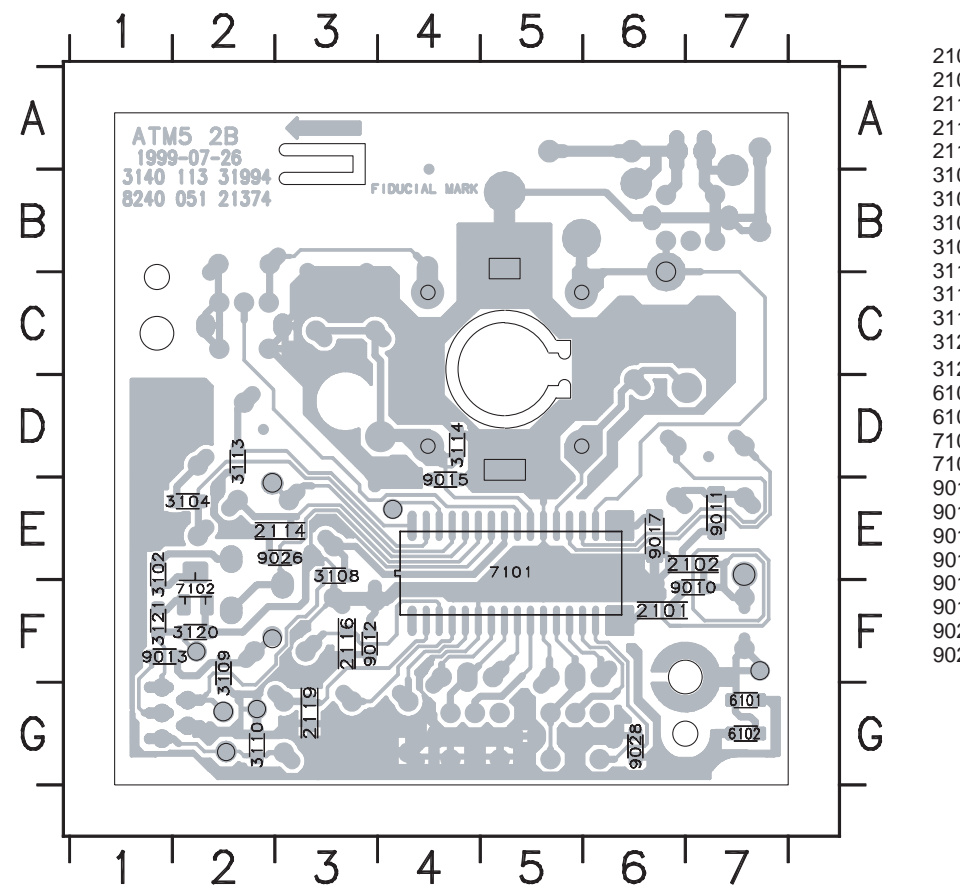

- 2101 F6
- 2102 E7
- 2114 E3
- 2116 F3
- 2119 G3
- 3102 E1
- 3104 E2
- 3108 E3
- 3109 F2
- 3110 G2
- 3113 D2
- 3114 D4
- 3120 F2
- 3121 F1
- 6101 G7
- 6102 G7
- 7101 E5
- 7102 F2
- 9010 F7
- 9011 E7
- 9012 F3
- 9013 F1
- 9015 E4
- 9017 E6
- 9026 E3
- 9028 G6

TUNER ADJUSTMENT TABLE

Waverange	Input Frequency	Input	Set tuned to	Adjust	Measure on	Scope / Counter
<b>OSCILLATOR</b>						
<b>FM</b> 87,5 - 108 MHz	87,35 MHz	<b>A</b>	lower band end	5104	<b>1</b> or <b>2</b>	
	108,25 MHz	$\Delta f = \pm 500\text{kHz}$ $V_{RF} = 100\mu\text{V}$	upper band end	2106 C1	<b>1</b> or <b>2</b>	
<b>MW</b> 525 - 1607 kHz (530 - 1710 kHz) <sup>1)</sup>	512 kHz (520 kHz)	<b>C</b>	lower band end	5105	<b>1</b> or <b>2</b>	
	1635 kHz (1730 kHz)	$\Delta f = \pm 30\text{kHz}$ $V_{RF} = 100\mu\text{V}$	upper band end	2106 C3	<b>1</b> or <b>2</b>	
<b>FM - RF</b>						
<b>FM</b> 87,5 - 108 MHz	87,5 MHz	<b>A</b>	87,5 MHz	5101	<b>1</b> or <b>2</b>	
	108 MHz	$\Delta f = \pm 500\text{kHz}$ $V_{RF} = 10\mu\text{V}$	108 MHz	2106 C2	<b>1</b> or <b>2</b>	
<b>VCO</b>						
<b>FM</b>	98 MHz	<b>A</b> continuous wave $V_{RF} = 1\text{ mV}$	98 MHz	3101	<b>3</b>	
<b>AM - IF</b>						
<b>AM</b>	468 kHz connect pin 24 of IC 7101 (AM Osc) with short wire to ground	<b>C</b> $\Delta f = \pm 15\text{kHz}$ $V_{RF} = 10\text{mV}$		5106	<b>1</b> or <b>2</b>	
				5108	<b>1</b> or <b>2</b>	
<b>AM - RF</b>						
<b>MW</b>	560 kHz	<b>B</b>	560 kHz	5111	<b>1</b> or <b>2</b>	
	1500 kHz		$\Delta f = \pm 30\text{kHz}$ $V_{RF}$ as low as possible	1500 kHz		

↑ repeat    <sup>1)</sup> for USA /17  
<sup>2)</sup> RC-network serves for damping the IF-filter while adjusting the other one.

RECORDER BOARD- CIRCUIT DIAGRAM

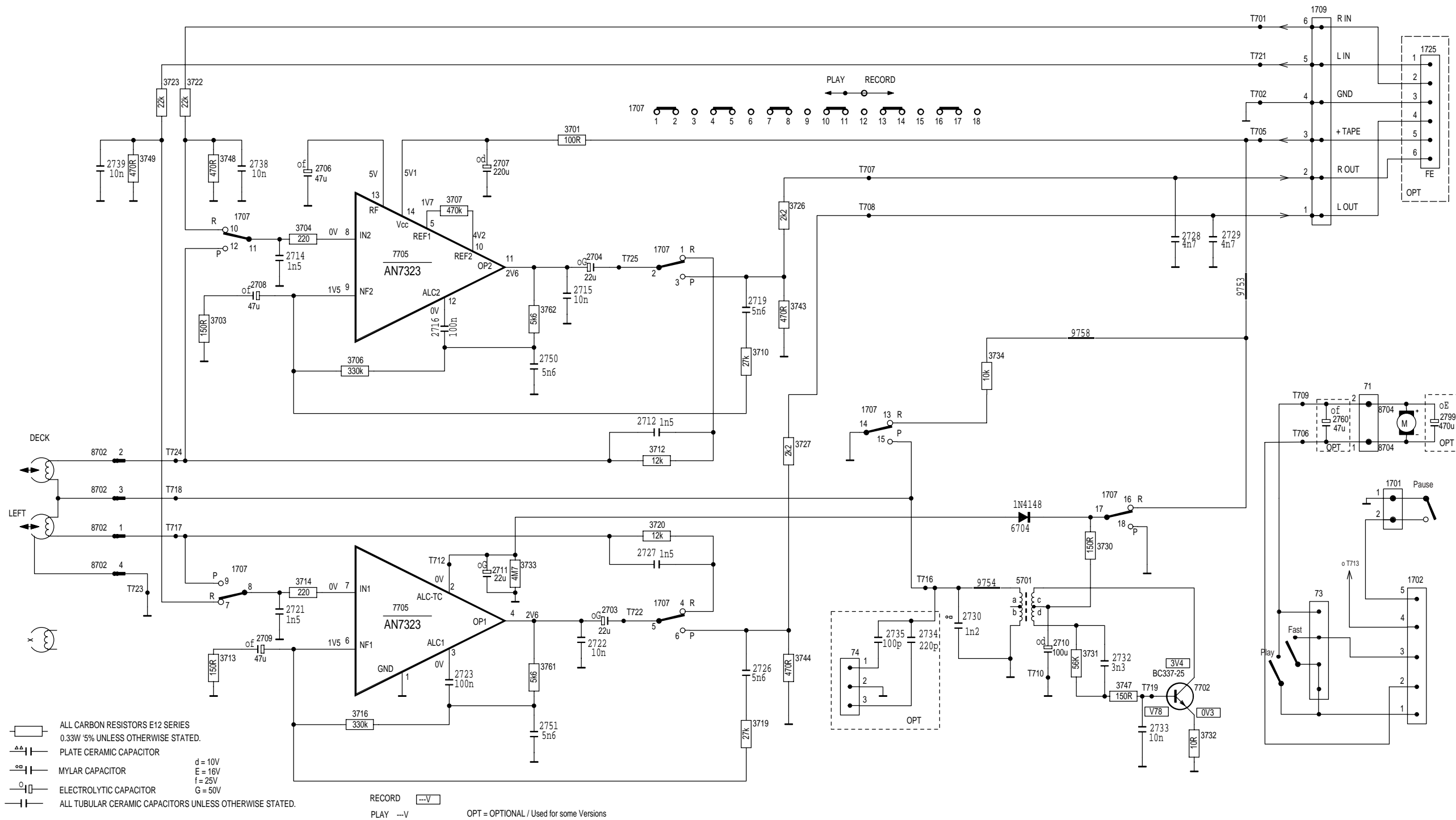

# RECORDER BOARD - LAYOUT DIAGRAM

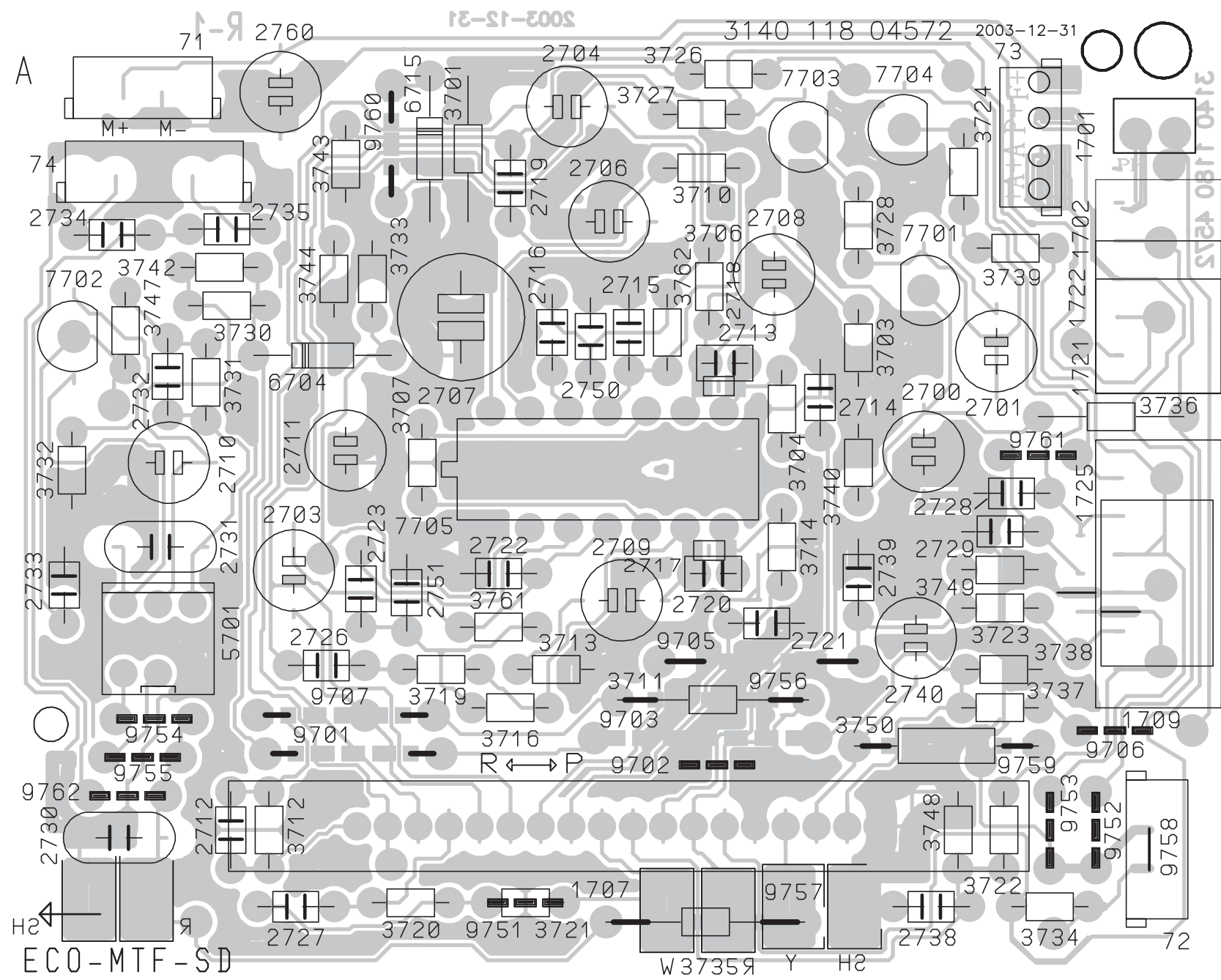

# COMBI BOARD - CIRCUIT DIAGRAM PART 1

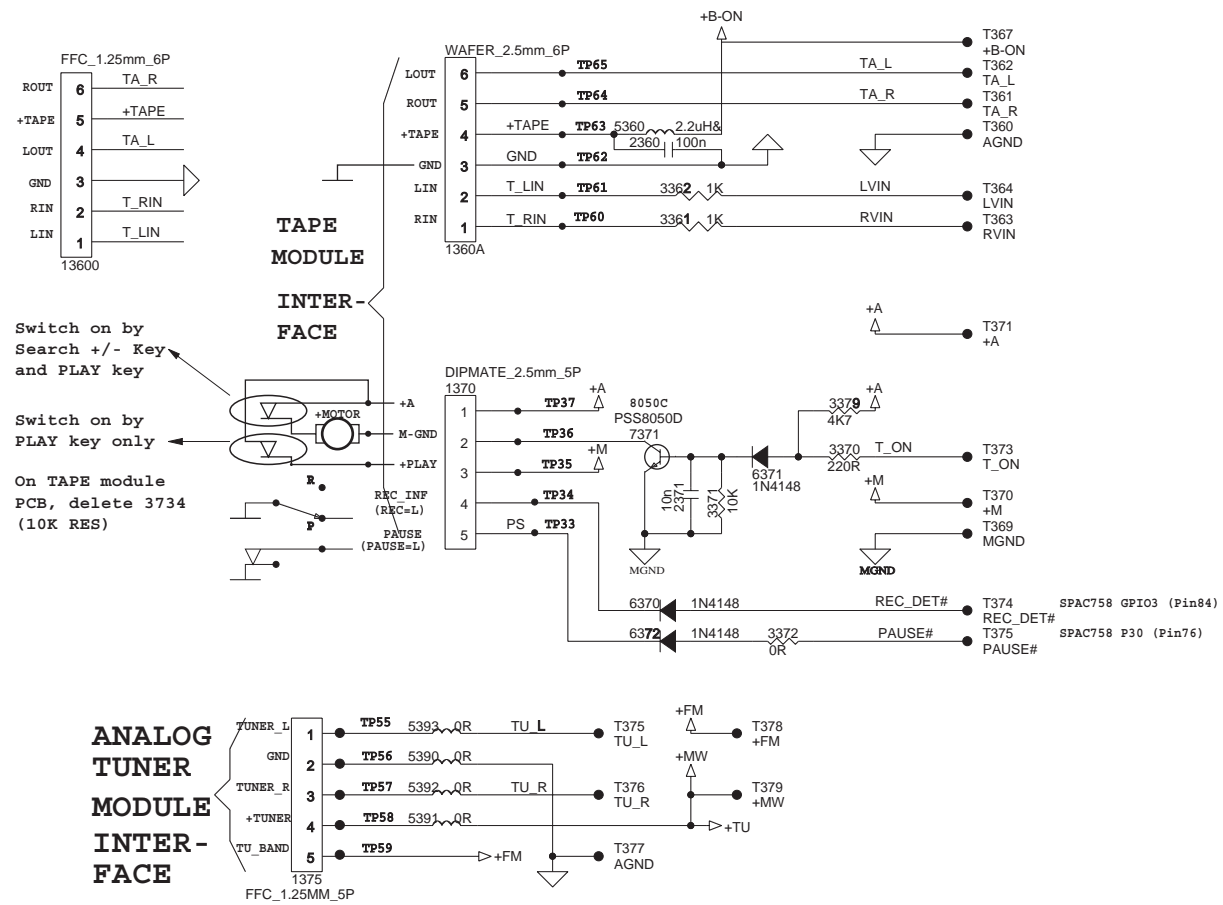

Ver0.5: 1. 1370 change to 5Pins WAREF for +A, M-GND, +PALY and REC\_DET#, PAUSE#

2. TAPE module should be chagned to support Power on by PLAY Key, and PAUSE Key detect.

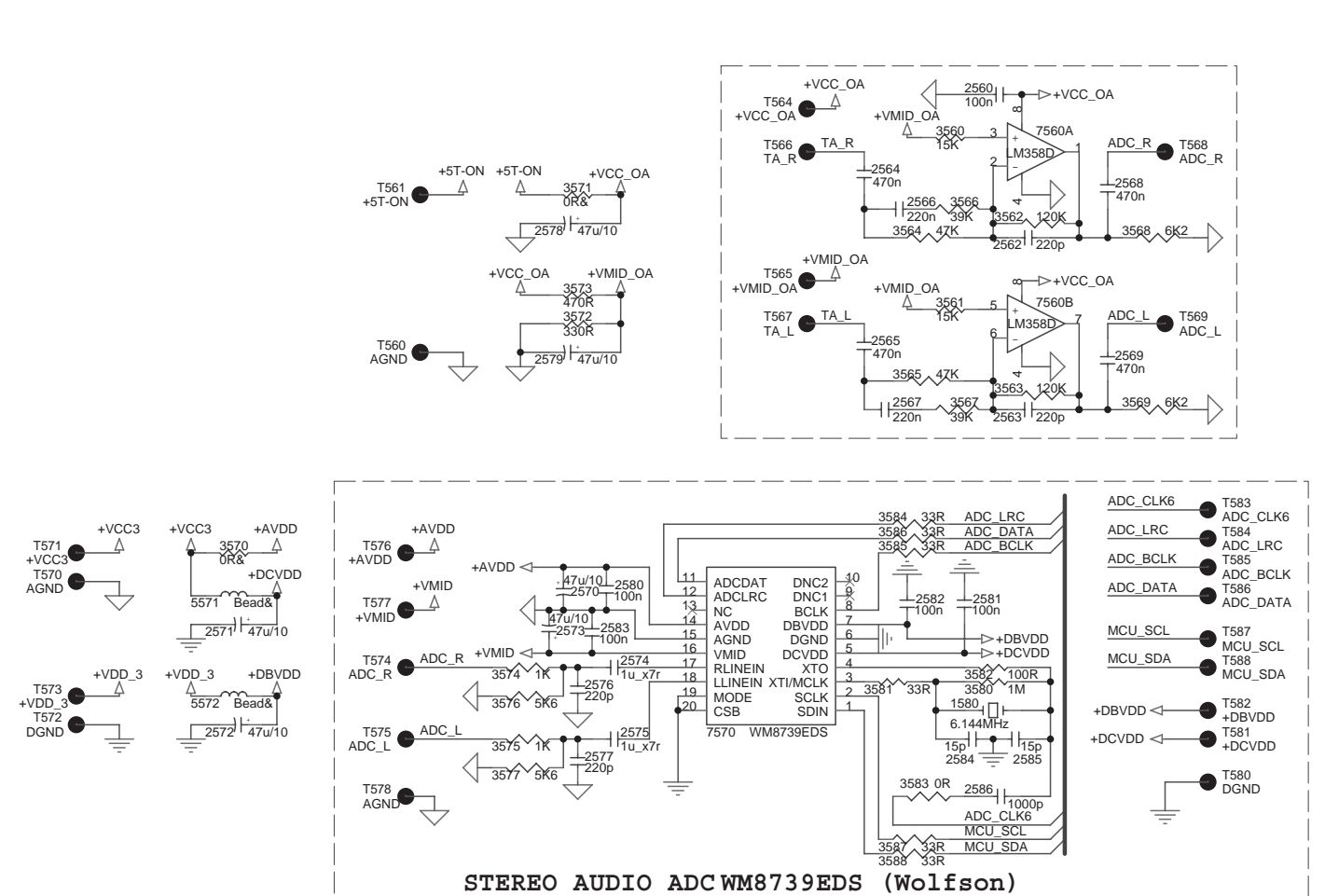

# COMBI BOARD - CIRCUIT DIAGRAM PART 2

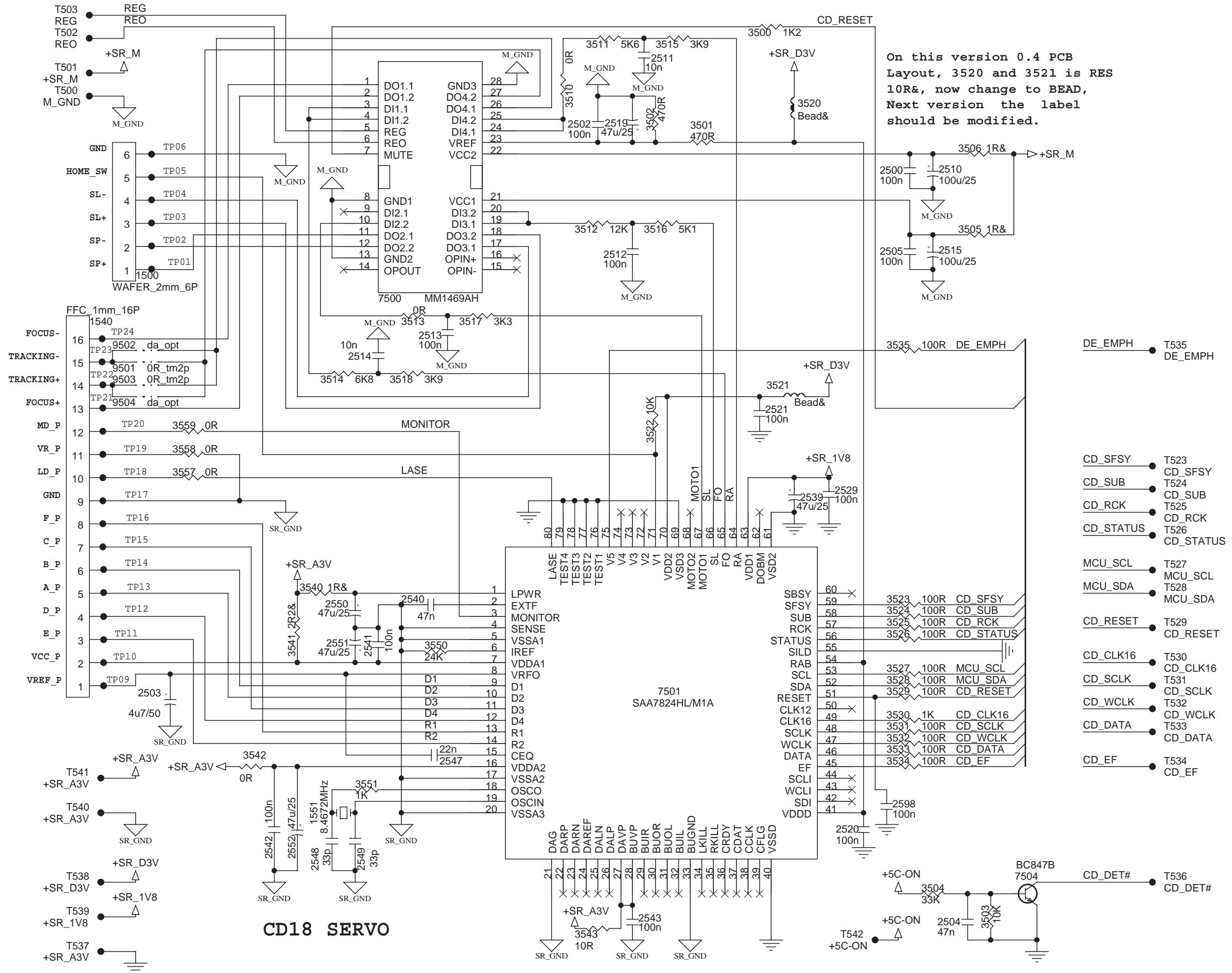

COMBI BOARD - CIRCUIT DIAGRAM  
PART 3

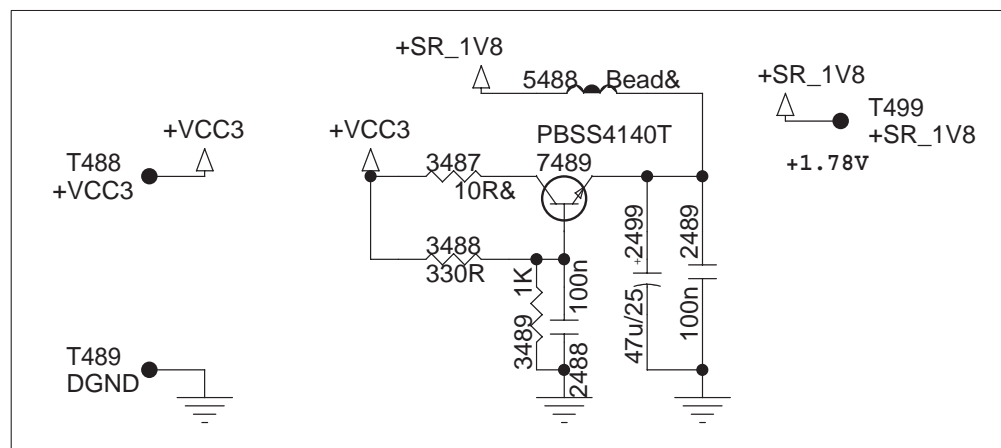
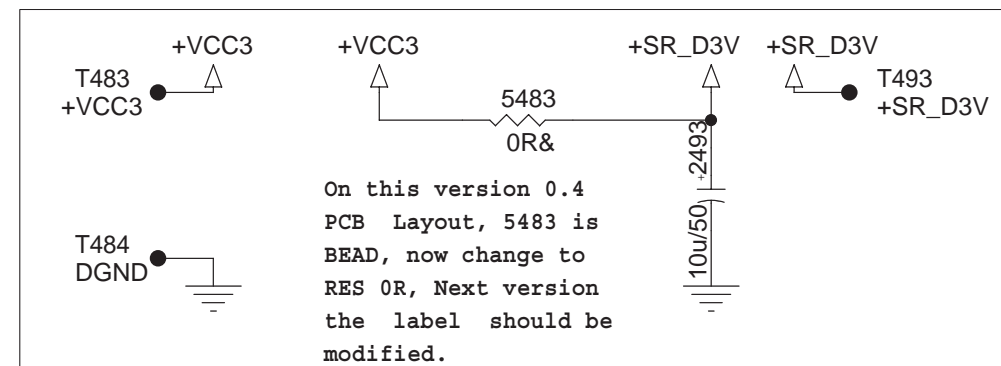
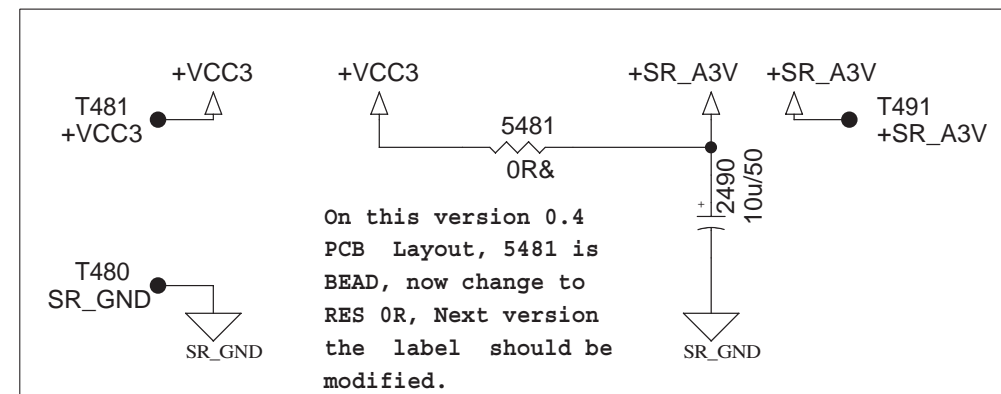
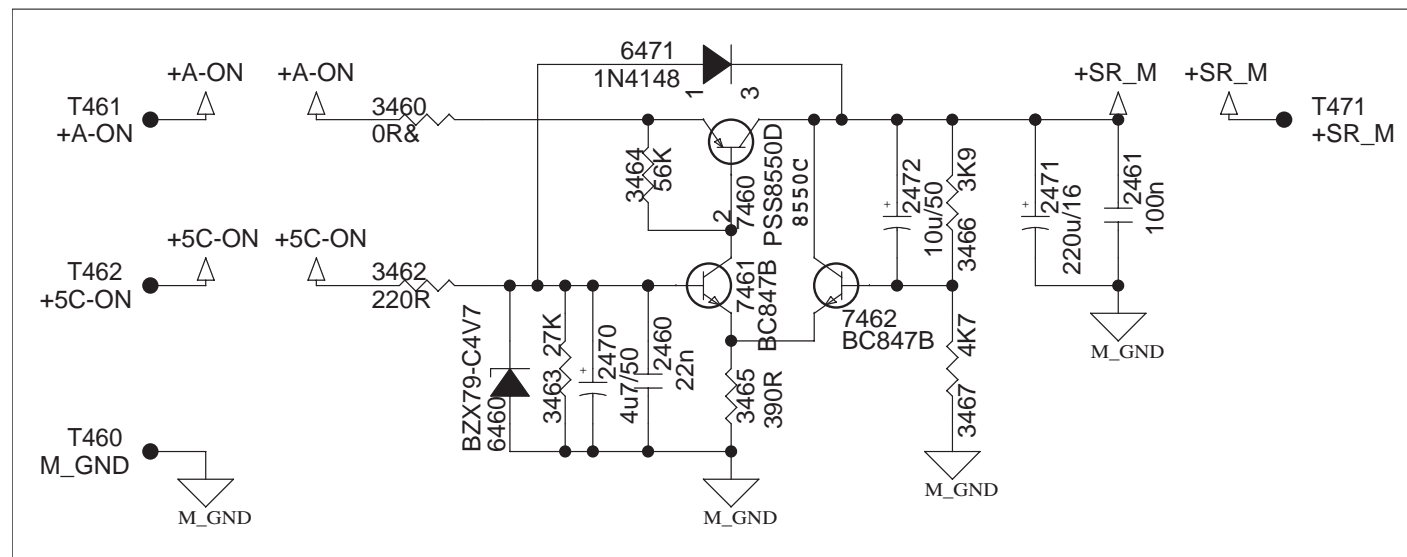
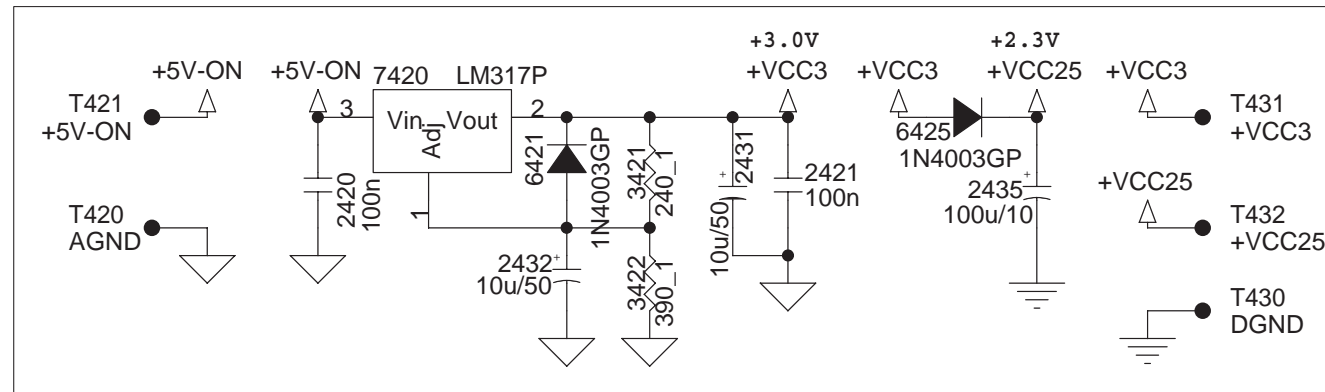
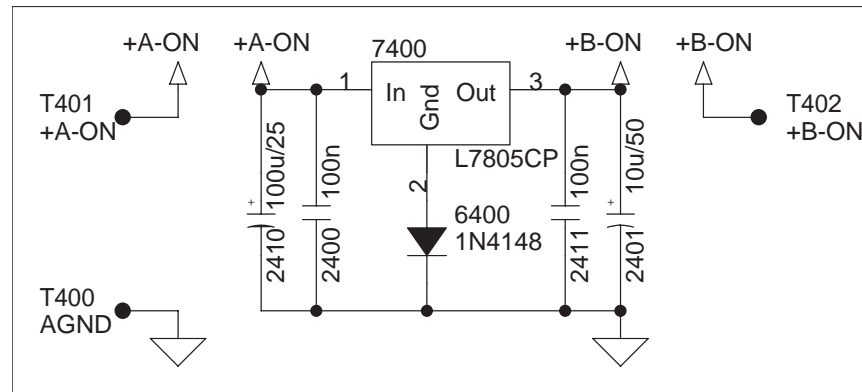



# COMBI BOARD - CIRCUIT DIAGRAM PART 4

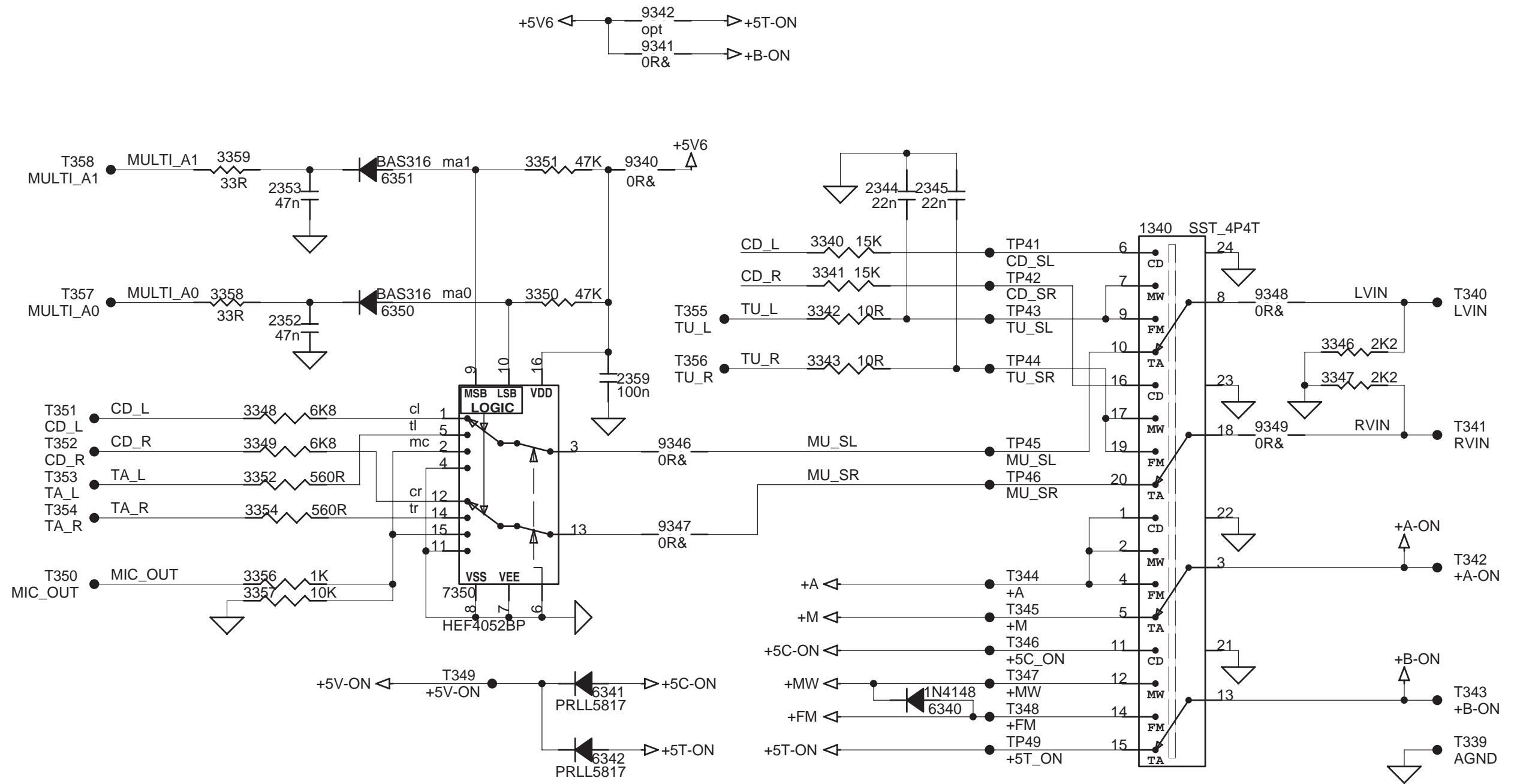

COMBI BOARD - CIRCUIT DIAGRAM  
PART 5

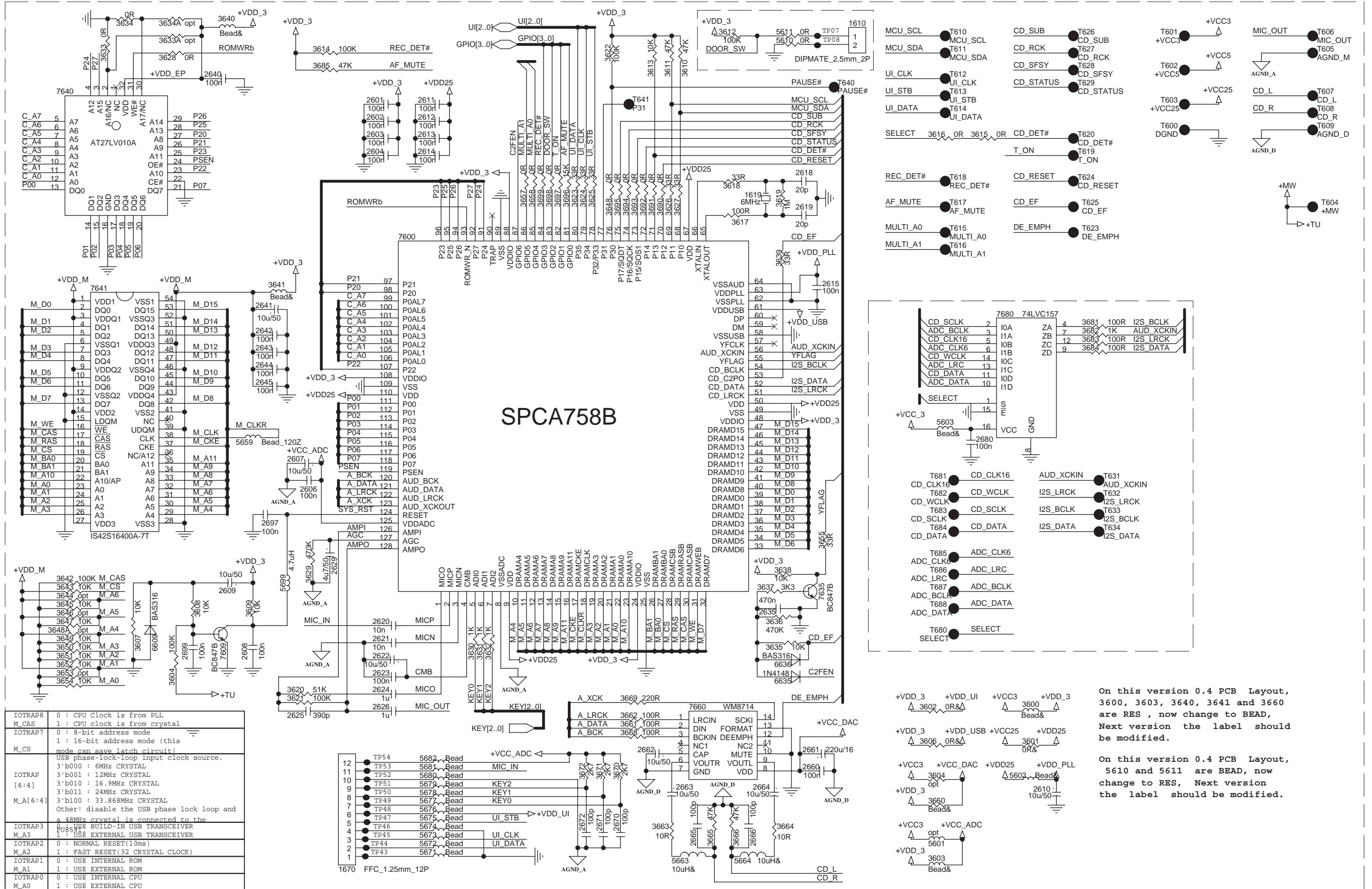

IOTRAP8	0 : CPU Clock is from PLL
M_CAS	1 : CPU clock is from crystal
IOTRAP7	0 : 8-bit address mode
M_CS	1 : 16-bit address mode (this mode can save latch circuit)
IOTRAP [6:4]	USB phase-lock-loop input clock source.
3'b000	: 6MHz CRYSTAL
3'b001	: 12MHz CRYSTAL
3'b010	: 16.9MHz CRYSTAL
3'b011	: 24MHz CRYSTAL
3'b100	: 33.868MHz CRYSTAL
Other:	disable the USB phase lock loop and a 48MHz crystal is connected to the
IOTRAP3	0 : USE BUILD-IN USB TRANSCIEVER
M_A3	1 : USE EXTERNAL USB TRANSCIEVER
IOTRAP2	0 : NORMAL RESET(10ms)
M_A2	1 : FAST RESET(32 CRYSTAL CLOCK)
IOTRAP1	0 : USE INTERNAL ROM
M_A1	1 : USE EXTERNAL ROM
IOTRAP0	0 : USE INTERNAL CPU
M_A0	1 : USE EXTERNAL CPU

Ver0.5: 1. Use SPCA758 P30 (Pin76) for TAPE PAUSE Key.  
2. Add Pull-up RES 100K for TAPE PAUSE Key.

On this version 0.4 PCB Layout, 3600, 3603, 3640, 3641 and 3660 are RES, now change to BEAD, Next version the label should be modified.

On this version 0.4 PCB Layout, 5610 and 5611 are BEAD, now change to RES, Next version the label should be modified.

# COMBI BOARD - CIRCUIT DIAGRAM PART 6

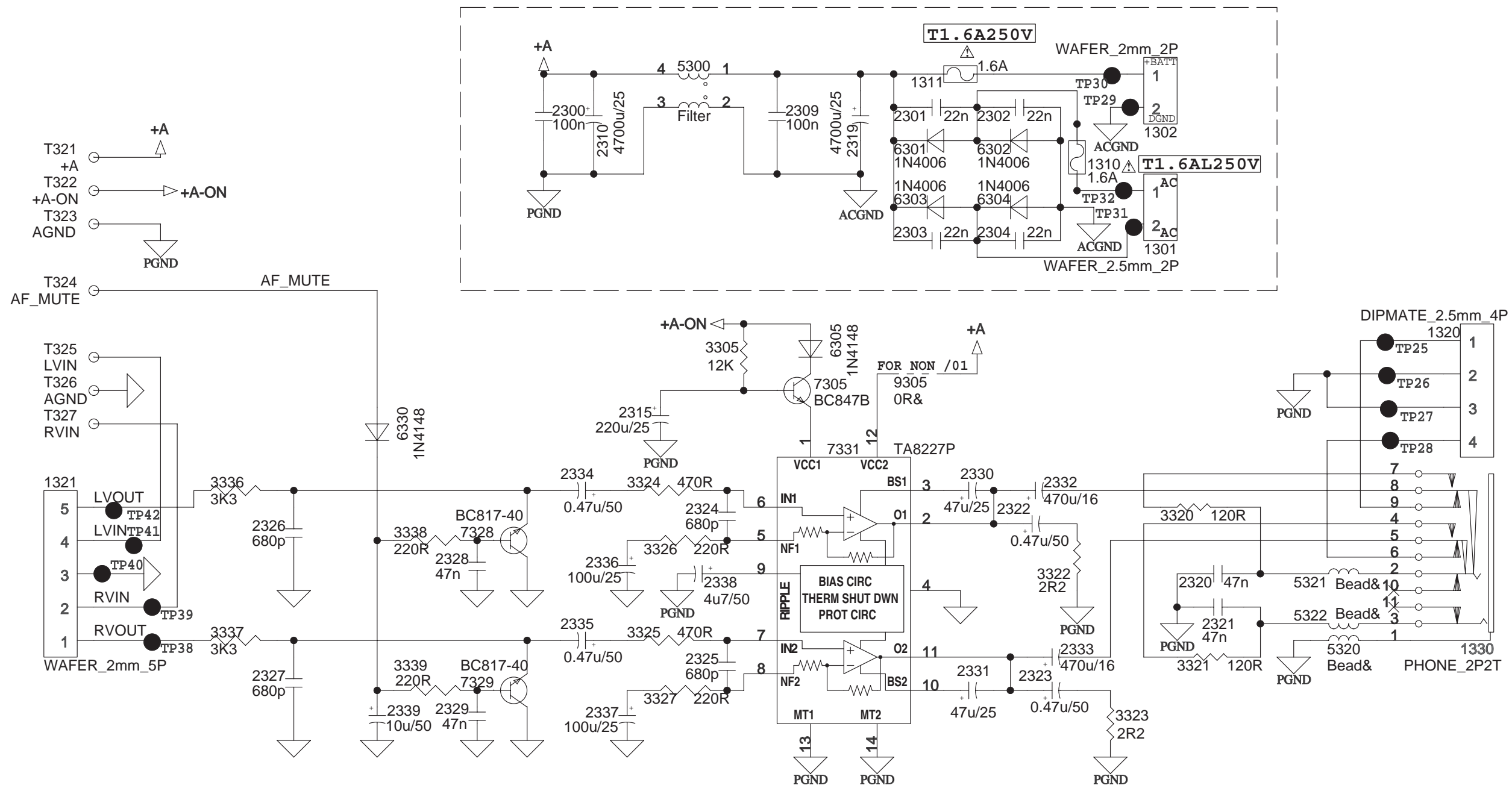

# COMBI BOARD (Copper Side) - LAYOUT DIAGRAM

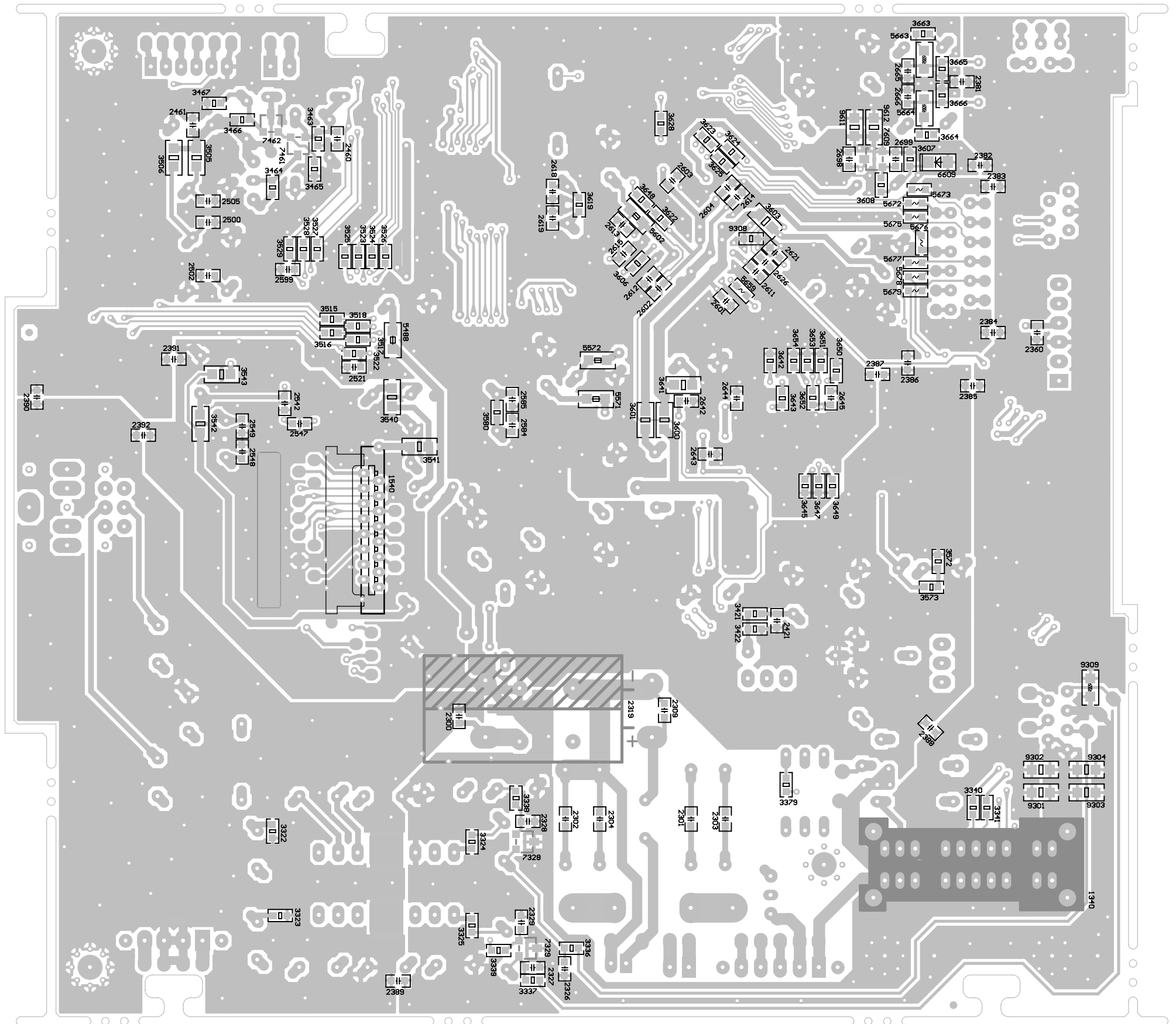



EXPLODED VIEW DIAGRAM

SCREW LIST :

①	M2.5x6
②	T2.5 x 8
③	T2.5 x 12
④	T3x 6
⑤	T3 x 8
⑥	T3 x 10
⑦	T3 x 12
⑧	T3 x 16
⑨	T3 x 20
⑩	T3 x 32
⑪	C P/W 2.5 x 10
⑫	T P/W 3 x 10
⑬	T P/W 3 x 16

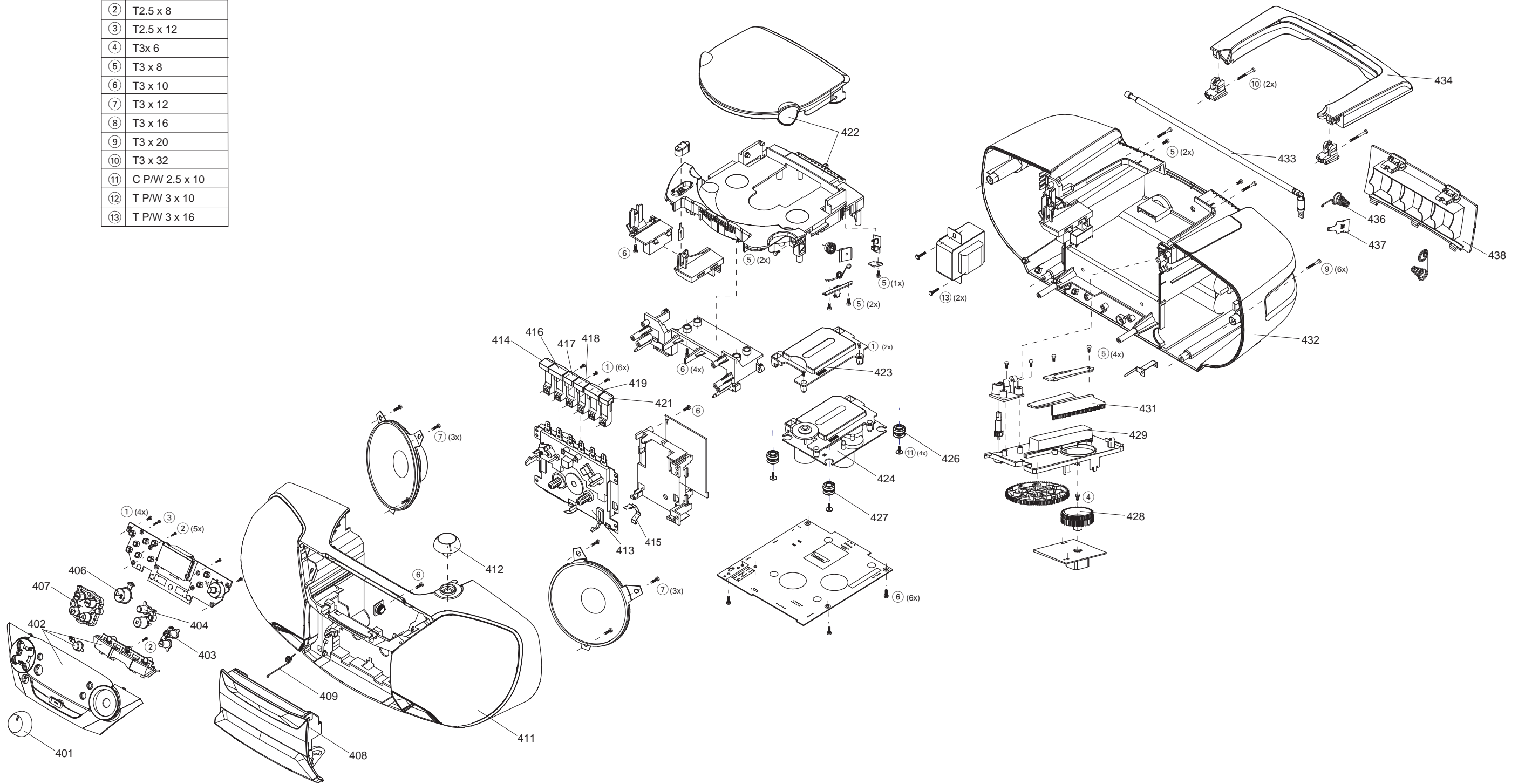

## MECHANICAL PARTSLIST

401	314011773371	VOLUME KNOB PNT
402	314011773151	FRONT PANEL ASSY
403	314011773412	SPEED+/- BUT PNT-AZ6188
404	314011773403	STOP/PROG BUT PNT-AZ6188
406	314011773391	PLAY KNOB PNT-AZ6188
407	314011773381	SEARCH/ALBUM BUT PNT-AZ6188
408	314011773131	CASS DOOR ASSY
409	314011101001	CASS DOOR SPRING
411	314011773091	FRONT CAB ASSY AZ6188
412	314011438941	TUNING KNOB
413	314011872251	TAPE DECK MECHANISM AZ6188
414	314011464001	CAS PAUSE-KEY BK
415	314011120804	SPRING-RECORDING
416	314011464011	CASS KEY(STOP)BK
417	314011464021	CASS KEY(F.F)BK
418	314011464031	CASS KEY(REW)BK
419	314011464041	CASS KEY(PLAY)BK
421	314011464051	CASS KEY REC BK
422	314011773111	CD TRAY ASSY AZ6188
423	310330466151	COVER-CD COMPATIBLE
424	242254945987	CD DRIVE DA11B3N (TSAJ) B
426	314011413892	DAMPER - RUBBER (30 DEG)
427	314011413902	DAMPER - RUBBER (35 DEGREES)
428	314011438761	GEAR PVC
429	314011438821	POINTER HOLDER
431	314011464241	POINTER AZ6188
432	314107750091	REAR ASSY AZ6188/01
433	314011871791	ROD ANTENNA
434	314011773141	HANDLE ASSY
436	314011101022	BATTERY SPRING"-"
437	314011121851	BATTERY CONTACT PLATE"+"
438	314011439091	BATTERY DOOR
	242207098151	MAINSCORD EUR 2A5 1M5 DET 2P B

**Note: Only these parts mentioned in the list are normal service parts.**

## ELECTRICAL PARTSLIST

**- MISCELLANEOUS -**

1007	314107830001	TFM POW EI-48
1008	242226400513	LSP 8R 3W
1009	242226400514	LSP 8R 3W
1011	242212700453	VOLTSEL 1P 2A H
1310	242208601218	FUSE 1,6A 250V
1311	242208610419	FUSE 1,6A 250V
1330	242202605602	SOC PHONE H 1P
1340	242212700538	SWITCH SLID
1551	242254301068	RES XTL 8MHZ4672 16P
1580	242254301439	RES XTL 6MHZ144 16P
1619	242254300873	RES XTL 6MHZ 16P
1707	242212802727	SWITCH PUSH 6P
1772	242212802917	SWIITCH-TACT
1773	242212802917	SWIITCH-TACT
1774	242212802917	SWIITCH-TACT
1775	242212802917	SWIITCH-TACT
1776	242212802917	SWIITCH-TACT
1777	242212802917	SWIITCH-TACT
1778	242212802917	SWIITCH-TACT
1779	242212802917	SWIITCH-TACT
1780	242212802917	SWIITCH-TACT
1781	242212802917	SWIITCH-TACT
1782	242212802917	SWIITCH-TACT
1783	242212802917	SWIITCH-TACT
1784	242212802917	SWIITCH-TACT
1790	314107850021	MICROPHONE
1806	242212000726	SWITCH-DET
2106	202080100022	CAP TUN 2XAM/2XFM
3771	212035490029	POTM CAR LIN 50KX2 E
5102	242253594985	IND FXD ANT 64μH 5%
5105	314011820011	MW OSC COIL 270μH RED
5106	314010733821	IFT-AM 7MM 146/5 180PH
5107	242254941126	FIL CERKIT 10MHZ7 KMFC5058-Z
5108	314010733591	IFT-AM 7MM 146T 180PH
5701	242254943582	IND VAR 7MM 7PA 100KHZ
7101	935068830118	IC SM TEA5711T/N2
7331	932206295682	IC TA8227P
7350	319801070290	IC SM HEF4052BT
7400	932202896682	IC L7805CP
7420	932212596687	IC LM317P
7500	932218855682	IC SM MM1469AH
7501	935272861157	IC SM SAA7824HL/M1A
7560	933984880668	IC SM LM358DT
7570	932220812668	IC SM WM8739EDS
7600	824000941891	IC SM SPCA758B
7640	932220839668	IC SM AT27LV010A-70JC
7641	932219938671	IS42S16400A-7T
7641	932216667668	MT48LC4M16A2TG-7E
7660	932220806668	WM8714ED
7660	932220807668	WM8725ED

**- MISCELLANEOUS -**

7680	935260898118	74LVC157AD
7705	932212960682	IC AN7323

**Note: Only these parts mentioned in the list are normal service parts.**